

Vol. 02 - Edition 05
2026

LUSX

LUXURY LIVING



FINE LIVING Finds & Trends

DESIGN DIVINE

Timeless Interiors

Art & Aesthete

LUXURY ESCAPES COLLECTION

Zannier Sonop, Namibia

ISSN 3079-630X



Premium Lifestyle & Hospitality Magazine



Maserati

MASERATI JOHANNESBURG

MASERATI CAPE TOWN SERVICE

Bryanston Boulevard, Winnie
Mandela Dr. +270800080077

Foreshore, 24, Christian
Barnard St. +270800060078

za.maserati.com



Official Timekeeper
of Formula 1®



*"I am not designed to come second or third.
I am designed to win."*

Ayrton Senna



DESIGNED TO WIN

TAG HEUER BOUTIQUES

SANDTON CITY, V&A WATERFRONT, GATEWAY

WWW.PICOTANDMOSS.CO.ZA





Mahali Mzuri | Maasai Mara



Finch Hattons | Tsavo

Experience the *ultimate* Kenyan safari

Journey from Mahali Mzuri's thrilling Great Migration spectacle in the Maasai Mara to Finch Hattons' red elephant paradise in Tsavo with stunning views of Mount Kilimanjaro. These two extraordinary safari camps offer contrasting landscapes, exhilarating wildlife encounters, luxurious tented suites, and mouthwatering culinary delights – all woven together with authentic cultural experiences that capture Kenya's wild heart and soul.



Photo credits for all publications/advertising: Photos by Flavien Carod and Baptiste Le Duinaou, not contractual. TASCAD, communication architectes, Spaceworkers

JOHANNESBURG – CAPE TOWN – MAURITIUS
In-store interior design & 3D modelling services.

Altea sofa, design Philippe Bouix
Trinta bookcase, design Fabrice Berrux.
Giorgia armchairs, design Bellavista & Piccini.
Niwa and Lan coffee table collection, design Dai Sugawara.
Cinecitta lamp, design Fabrice Berrux.
Pulse rug.

rochebobois
PARIS



11



22

11 STAY CONNECTED

Nile Royale
Sail in splendour

22 GLITZ & GLAM

In the name of Valentino

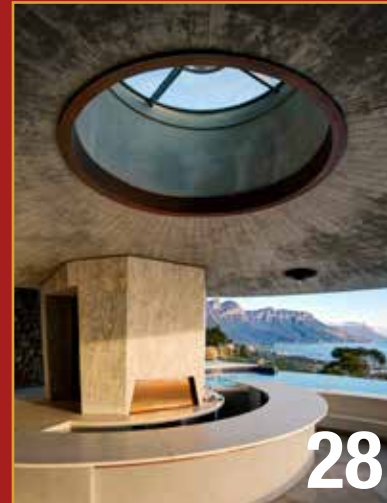

28



38

28 DESIGN DIVINE

Peerutin Karol
Contemporary and timeless

38 Maryna Pupcha

Where folk dances with future

54 INTERNATIONAL ESCAPES

Zannier Sonop, Namibia



54



62

62 ART LOVERS

Johan Swart Ceramics

66 LUXURY AFRICAN ESCAPES COLLECTION

Anantara Collection



66

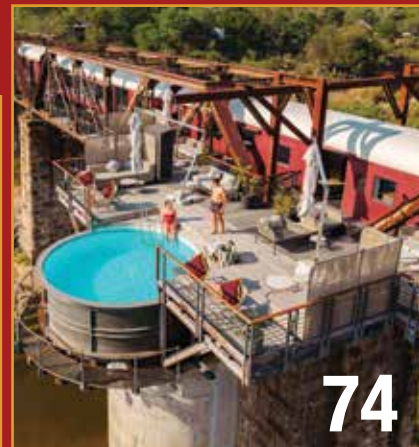

74

74 The Train on The Bridge

All rights reserved. Whereas precautions have been taken to ensure the accuracy of information, neither the editor nor the publisher can be held liable for any inaccuracies, error or omission, injury or damages that may arise. The opinions expressed in the editorials may not reflect those of the publisher.



Media-Avenue | Publisher
M Collins Managing Editor | L Marcus Business Manager
Design Bandits Graphics | D Meyer Digital



m@media-avenue.site
PO Box 412147 Craighall 2024
Media Avenue (Pty) Ltd 2024/633396/07



www.luxliving.com
www.media-avenue.site



+27 82 410 7863
+27 11 268 0852



CHEETAH PLAINS
PRIVATE GAME RESERVE SABI SAND

AFRICA'S MOST EXCLUSIVE SAFARI
DESIGNED FOR SOUTH AFRICA'S OWN.

CHEETAHPLAINS.COM



H. Moser & Cie.

VERY RARE

by nature



*Streamline
two billion
skeleton*



h-moser.com



BOUTIQUE HAUTE HORLOGERIE
V&A WATERFRONT CAPE TOWN +27 21 418 1889
HYDE PARK CORNER JOHANNESBURG +27 11 325 4119
For further information contact Architects of Time +27 11 669 0790
www.bhhboutique.co.za

17

18

NILE ROYALE

Sail in Splendour



Explore the world's longest river in the lap of luxury
Hilton is the latest hospitality heavyweight to dive into super yacht cruises. The American company has announced its flagship luxury brand, Waldorf Astoria, will begin offering voyages, bringing even more of the five-star hotel experience to the water. The new super yacht will allow travellers to explore the world's longest river in the lap of luxury. Ranging from four to six nights, the itineraries spotlight some of Egypt's most famous landmarks. The routes run either downriver from Luxor to Aswan or upriver from Aswan to Luxor, with private docks in both locations.



CAPE COD

True to its original "square within a rectangle" outlines, the Cape Cod watch redefines the contours of an iconic design.

Born of Henri d'Origny's bold pencil strokes and inspired by the anchor-chain link, the Cape Cod watch appears in revised proportions vividly showcasing its personality. Endowed with the same graphic typology,

visual language and timeless sassiness, the new Cape Cod features all the architectural vocabulary of its 1991 predecessor, reinterpreted with exquisite finesse in a "mini" version.



Appearing in a 27 x 20 mm format that accentuates the curve of its case and its finishes - sometimes smooth and at others shiny, gem-set or polished - this watch with its iconic link is available in steel or yellow gold. The argenté, étoupe or ardoise dials lend their understated elegance to the steel case, while the yellow gold version glows with a doré or Rouge H hue.

Crafted in the Hermès Horloger workshops, a single or double tour strap in Swift calfskin or Chamkilight goatskin highlights the subtle nuances of each individual dial.

Boutique Haute Horlogerie
Cape Town: V&A Waterfront
+27 21 418 1889
Johannesburg: Hyde Park Corner
+27 11 325 4119
www.bhhboutique.co.za

MC.

Fairytale Castle Just An Hour Outside Of Copenhagen

Frederiksborg Castle stands as the grandest Renaissance estate in the Nordic countries. It is filled with intricate rooms, dramatic art, and history that breathes from the ornate walls. The gardens are straight out of a fairy tale, while the interiors are grand without feeling cold or distant. It's the rare kind of place that feels like a real-world time machine.

Built in the early 1600s, this Renaissance wonder is home to Denmark's National History Museum and Portrait Gallery. Outside, lakes and gardens – including a formal Baroque space and a quiet landscape park – invite you to slow down and take it all in. It's undoubtedly the best way to see Frederiksborg Castle and enjoy Copenhagen's hidden gems.



"The future of African mining will not be defined solely by how much we extract, but by what we build, what we retain, and what we pass on."

MineShift2026

Mine to Market calls for a New African Mining Legacy Beyond Extraction. The event, hosted by MetCon, took place in February in Cape Town, bringing together stakeholders from across the mining, jewellery and luxury value chain.

Mine to Market brought together mining leaders, policymakers, investors, jewellers, designers, and cultural voices to explore a future where Africa's minerals generate enduring value beyond extraction, hosted at Zeitz Museum of Contemporary Art Africa (Zeitz MOCAA) the largest museum of contemporary art from Africa and its diaspora. The museum is located in the Silo District at the Victoria & Alfred Waterfront in Cape Town.

The event reframed mining as both a finite act and a starting point, asking what is built, retained, and passed on once minerals leave the ground. It challenged conventional narratives around Africa's role in global mineral economies, positioning the continent not merely as a source of raw materials, but as a creator of long-term industrial, cultural, and brand legacy.



SEZ: +27 (0) 12 000 4440 | CPT: +27 (0) 21 510 0770
metcon.co.za | info@metcon.co.za



The spouse of one of Asia's wealthiest tycoons Mukesh Ambani, transforms an exceptionally rare luxury Birkin into a near-million-dollar keepsake, adorning it with custom gold charms, sparkling diamonds, and vivid gemstones that represent her grandchildren's initials.

The woman in her early sixties, who owns a prominent professional cricket franchise, has invested heavily in these lavish enhancements. Each initial is crafted from solid high-purity gold. The decorative charms are encrusted with fine diamonds, alongside a striking gemstone known for its glowing, electric colour. This gem is considered extraordinarily scarce, with only a tiny number discovered compared to the vast quantities of diamonds mined.



ICE CUBE



BHH BOUTIQUE V&A WATERFRONT CAPE TOWN +27 21 418 1889
BHH BOUTIQUE HYDE PARK CORNER JOHANNESBURG +27 11 325 4119
For further information contact Architects of Time +27 11 669 0790
www.bhhboutique.co.za

This new luxury train journey around France is a wine lover's dream

Imagine sipping champagne in Reims, exploring the sun-kissed villages of Provence, and indulging in fine dining at the Alexandre Dumas Restaurant, helmed by a Three-Michelin-starred chef... Le Grand Tour is the ultimate luxury train experience in France, offering a five-night, six-day journey through the country's most iconic regions.

This luxuriously restored Belle Époque-style train travels from Paris through the famed regions of Champagne, Bordeaux, and the Loire Valley. A boutique travel at its most poetic; a seamless blend of cultural immersion, fine dining, and slow luxury. This curated experience offers a new way to sip champagne, both literally and figuratively. Your suite aboard Le Grand Tour is lavish, with plush linens, en-suite bathrooms, and panoramic windows. With only 36 guests and 15 crew members, Le Grand Tour offers an intimate, immersive

of Champagne, where Gothic grandeur and effervescent indulgence coexist. You will be taken on a tour of the Reims Cathedral, a UNESCO World Heritage site where 33 French kings were crowned, and the adjoining Palais du Tau, a cultural landmark once the Archbishop of Reims' palace. As the train glides into the Champagne region, guests disembark for the chalk cellars of Maison Ruinart, the oldest established Champagne house. Here, a guided descent into the luminescent caves unveils centuries of winemaking tradition – capped by a tasting, of course.

Onboard, expect more than just white-glove service. Theatre artists and storytellers perform vignettes throughout the journey, weaving historical anecdotes and local legends into the itinerary. It's not uncommon for a costumed noble to pass through the dining car mid-dinner or a violinist to serenade passengers at sunset.

Off-train excursions are equally curated. In the northern town of Épernay, stroll down the famous Avenue de Champagne – often called the richest avenue in the world due to its quantity of champagne stored in underground cellars – where guests are granted private tastings, like the one at the houses Moët & Chandon. In the Loire Valley, Le Grand Tour guests may find themselves enjoying an after-hours château visit – no crowds. Meals on Le Grand Tour are prepared by a three-star Michelin chef preparing curated menus inspired by the villages you pass by. Each course is paired with wines and champagnes chosen by an onboard sommelier.

Note: Prices start from £19,999 (fully inclusive).



Travel asleep across Europe

Europe's new luxury night-bus with its lie-flat beds, feels like flying business class. Swiss company Twi liner is reimagining long-distance bus travel with comfort usually found in the air.

The new service, connecting iconic cities, launched in November 2025. The night-bus features 21 seats on a double-decker (18 on the upper level and three on the lower level), each of which recline into a fully lie-flat bed. Each bus features free Wi-Fi, an onboard bar, a toilet and a separate change room. The bus includes a luggage storage area with each passenger able to bring one large suitcase and one carry-on with them, for free. Every seat includes a personal storage area, a table, USB chargers, and a reading light. But unlike a first-class cabin on a plane, these buses don't include any dedicated on-board service.



experience. This Belle Époque-style train takes you on a curated adventure through France's cultural tapestry, with exclusive access to the Champagne Cellars of the oldest established Champagne house; Loire Valley's Châteaux, known as the "Castle of Ladies"; Bordeaux's secrets of Saint-Emilion's prestigious Grands Crus châteaux; Provence's Hidden Gems; the best-kept secrets of Avignon's Palace of the Popes and more.

France's Champagne region has long been synonymous with elegance, but Le Grand Tour elevates the experience into something transcendent. The journey begins in the northeastern city of Reims, the unofficial capital

China's 1,000km/hr trains with 5G network will rival planes

China is testing next-generation trains that will soon surpass planes in terms of speed. According to South China Morning Post (SCMP), tests are underway for the high-speed trains that will achieve speeds up to 1,000 km/h. Interestingly, scientists are using levitation technology to propel the trains in near-vacuum tubes. This technology works on the same lines as Elon Musk's hyperloop idea. The billionaire established The Boring Company to dig tunnels underground and use autonomous electric pods that will travel at nearly 1,000km/h.



AI generated

"The Octo Finissimo 37 marks a significant evolution for Bvlgari. It is the watch of maturity. By reinterpreting the Octo Finissimo codes with this new dimension, we have created a timepiece that goes beyond technical prowess to fully embrace the contemporary art of living. It achieves a perfect balance between subtle elegance, absolute comfort on the wrist, and horological innovation that continues to push boundaries. This is a true object of desire, a timeless signature for those who refuse to compromise between style and substance", explains Jean-Christophe Babin, CEO of LVMH Watches and CEO of Bvlgari.

In that sense, the new Octo Finissimo is closely aligned with Italian sprezzatura: an effortless blend of elegance. Subtle, cultivated and unmistakably Italian, it is a way of carrying oneself. With the precision of its proportions, the new Octo Finissimo slips easily beneath a shirt cuff, complementing a modern, refined wardrobe. The bracelet stands out with an innovative design, integrating a push-button clasp for brilliantly optimized ergonomics. This perfection extends to the junction of the case and bracelet, now achieved through a screw-fastening system. It has been engineered to work seamlessly with different materials and finishes - an integration of absolute precision, creating both aesthetic and functional unity.



Johannesburg: Bvlgari Boutique Sandton City +27 11 883 1325

BVLGARI



A Fairytale castle, turned 5-star hotel, in Sintra, Portugal

The royals of Portugal used to live in the palaces of Sintra and Valverde. Sintra's Palácio de Seteais allows you to relive this experience...

Nestled in the misty hills of Sintra, this former palace has been lovingly restored from centuries of history into a 5-star hotel where old-world grandeur meets modern luxury. Ornate frescoes, manicured gardens, and sweeping views of the mountains create the feeling of stepping into a living fairy tale, while discreet contemporary amenities ensure effortless comfort. Staying here feels like inhabiting a royal dream – timeless, elegant, and quietly magical.

Sintra's Palácio de Seteais is more than just a five-star hotel and luxury experience. It is included in the UNESCO cultural landscape of Sintra, a World Heritage Site.





CALIBRE E5
SBT8A85.EB0417



CONNECTED TO FORMULA 1®

As the Formula 1® season gears up, TAG Heuer launches an avant-garde expression of the TAG Heuer Connected Calibre E5 45mm x Formula 1®.

Swiss luxury watchmaker TAG Heuer reveals the TAG Heuer Connected Calibre E5 45 mm x Formula 1, a titanium powerhouse designed to race with the thrill of every Grand Prix™. Fueled with speed, style, and digital innovation, this special edition puts the excitement of the Formula 1® season on the wrist, keeping fans in the heart of the action from the first turn to the checkered flag.



CASE SIZE: 45MM
CASE MATERIAL: TITANIUM
THE F1 LOGO, FORMULA 1, GRAND PRIX AND RELATED MARKS ARE TRADEMARKS OF FORMULA ONE LICENSING BY TAG HEUER (SCHAFFHAUSEN), A MEMBER OF LUXURY GROUP MANUFACTURES S.A. (LUSSEMBOURG).



THE F1 LOGO, FORMULA 1, F1 GRAND PRIX AND RELATED MARKS ARE TRADEMARKS OF FORMULA ONE LICENSING BV. TAG HEUER FORMULA 1 IS A TRADEMARK OF LVMH. SWISS MANUFACTURE. ALL RIGHTS RESERVED.

Timing the Legends

Since its earliest days, TAG Heuer has been deeply engaged in motorsport, sharing the same dedication to precision, innovation, and performance that drives every race. The brand's presence has shaped milestone eras in racing, from historic alliances with legendary teams such as Ferrari and McLaren to its ongoing partnership with Oracle Red Bull Racing, a collaboration that has witnessed some of the most memorable chapters of contemporary Formula 1®.

Over decades, TAG Heuer has stood alongside the sport's greatest drivers, from historic icons like Joe Siffert, Ayrton Senna, Steve McQueen and Jochen Rindt to today's stars including Max Verstappen. Its precision timing has measured victories and podiums across more than 230 Grand Prix™, 15 FIA Formula 1® Drivers' World Championship titles, and 11 FIA Formula 1® Constructors' World Championship titles, helping to define the legends of the sport.

TAG Heuer strengthened its connection to motorsport as Official Timekeeper of Formula 1®, a role, previously held by the brand from 1992 to 2003, reaffirming the Maison's ties to racing and its commitment to innovation and the thrill of competition.

Extending this legacy into the digital era, TAG Heuer pioneered the luxury connected watch segment in 2015, combining the refinement of traditional watchmaking with a state-of-the-art digital experience. The TAG Heuer Connected Calibre E5 45 mm x Formula 1 bridges heritage and technology, bringing the world of the Grand Prix™ directly to the wrist. It immerses those who wear it in the energy, intensity, and passion of the Formula 1® season, capturing the essence of the championship wherever they are.

The Buzz of the Grand Prix™ at any time

The TAG Heuer Connected Calibre E5 x Formula 1 brings the pulse of every Grand Prix™ to life, keeping a constant connection to the championship so no moment is ever missed. From the first practice session to race day, the entire season becomes a seamless, uninterrupted experience, generating pure racing emotion from start to finish.

At the heart of this edition is the hero watch face, the Race Track, with digital time displayed beneath the track outline and a design that adapts to each Grand Prix, represented by the country flag, race name, and its own racetrack silhouette. The watch evolves automatically throughout the seasons, featuring 24 unique designs for 24 Grand Prix weekends to create a dynamic connection to the championship. As a final playful detail, a moving dot travels around the circuit outline to indicate the passing seconds. Alongside the Race Track face, all the classic TAG Heuer watch faces are re-designed to perfectly match the TAG Heuer Formula 1 edition and the physical watch, ensuring every style reflects the spirit of the track.

At the center of the experience, is the exclusive The Formula 1® app, a direct line to the championship. Accessible via a dedicated entry in the watch menu, it provides access to the season calendar, Grand Prix schedules, post-race results, and driver and team standings, sourced directly from the race schedules. It ensures that no result, no session, and no ranking is ever missed. With smart widgets delivering key updates instantly without opening the app, the wearer stays connected to the championship at every moment, before, during, and after each Grand Prix.

Every element of the system is designed for an authentic and ultimate 360 Formula 1® experience. Custom sounds and branded icons add subtle racing flavor to the experience with a set of branded icons and notifications mimicking pit radio communications, so every alert feels like a call straight from the pit wall, making the wearer the driver of its own race story. Animated bezel markings and circular complications highlight each phase of the race weekend, allowing the wearer to follow FP1, FP2, FP3, Q1, Q2, Q3, and the Grand Prix™ race at a glance.

Beyond the Formula 1® experience, the latest Calibre E5 transforms everyday interaction into a seamless, engaging journey. TAG Heuer OS guides with intuitive navigation, responsive haptics, and notifications that are felt and heard. Integrated wellness features track activity, sleep, and heart rate, translating data into clear insights that inspire movement and push limits, while dual-band high-precision GPS captures every outdoor adventure with uncompromising accuracy. Elegant, versatile and technologically advanced, the Calibre E5 makes every second pulse with the energy of the track.



On the Canvas of Speed

The TAG Heuer Connected Calibre E5 45 mm x Formula 1 channels the essence of the Formula 1® racing in every detail. Its brushed and sandblasted Grade 2 titanium case features a black DLC coating, with the phases of a Grand Prix weekend displayed along the curved touchscreen bezel. Integrated pushers with black DLC and red lacquer accents, a black rubber and black DLC steel crown add a subtle racing touch. A heart rate sensor and the red Formula 1® logo on the caseback celebrate the collaboration and reinforce timepiece's high-octane identity.

Two specially crafted straps complement the experience. The first combines black leather with a carbon pattern and a black rubber base, accented with striking red stitching, reflecting the iconic colours and spirit of Formula 1®. The second, a flexible stretch textile strap with self-fastener closing system, offers comfort for sports or sleep tracking while remaining true to the Grand Prix™ character.

The special packaging mirrors the Formula 1® DNA, with matte black, soft-touch surfaces and glossy checkered patterns reminiscent of the finish line flag. Precision-cut panels open in a multi-stage motion to reveal the watch, combining luxury and motorsport-inspired visual cues for an unforgettable unboxing experience.



TAG Heuer Connected Calibre E5 45mm x Formula 1®

SBT8A85.EB0417

Calibre E5

Hardware

Battery life: 2 days with full performance / 3 days in "Low Power Mode"

Charging time:

100% in 90 min at temperatures between 15° and 45°C

Fast charging: 1 day of battery life in only 30 minutes

Sensors: heart rate monitoring, calories, steps counter, compass, accelerometer, gyroscope, barometer, blood oxygen saturation, breathing rate, sleep tracking, heart rate variability, GNSS dual band (see details below)

Chipset: Qualcomm Snapdragon 5100+

Connectivity: BT 5.3, Wi-Fi, MFi

GNSS: Dual Band (L1 + L5), GPS, GLONASS, BeiDou, QZSS, Galileo

Display: AMOLED tactile display 1.39", 454x454 (326 dpi)

User Interfaces: 2 mechanical buttons, 1 mechanical crown, microphone, speaker, haptics

Operating System

TAG Heuer OS

Watch Experience (Custom built TAG Heuer apps)

TAG Heuer Watch Faces & Complications, with exclusive Formula 1 Watch Faces

TAG Heuer Sports Watch App: Running, Cycling, Swimming, Workout, Hiking, Golf and TAG Heuer Wellness

Formula 1 App and Formula 1 Widgets

Call Management (with paired compatible smartphone), Voice assistant Controller, Media controller, Notifications

Other TAG Heuer branded utility apps: Stopwatch, Timer, Alarm, Calendar

Case

45mm diameter

Black DLC grade-2 titanium brushed and sandblasted case

Black polished ceramic bezel with Formula 1 phases engravings

Flat sapphire crystal

Black steel crown with black rubber

Black DLC steel shaped push-button with red lacquer at 2 o'clock

Black DLC steel shaped push-button with red lacquer at 4 o'clock

Black DLC grade-2 titanium caseback

Water resistance: 50 meters

Bracelet

Bi-material strap following F1 color codes with black leather with carbon pattern, black rubber base and red stitching

Black interchangeable DLC steel folding clasp with double safety push-buttons; TAG Heuer shield



TAG HEUER BOUTIQUES

CAPE TOWN: V&A Waterfront +27 21 421 8539

JOHANNESBURG: Sandton City +27 11 784 7422

DURBAN: Gateway Shopping Centre +27 31 566 4452

For further information contact Picot & Moss +27 11 669 0500

www.picotandmoss.co.za





In the name of Valentino

A life in couture, a career in beauty, and the legacy of a man who never stopped believing in glamour

There are designers, and then there are *institutions*. **Valentino Garavani** is firmly in the latter category – a man whose name alone conjures silk draped just so, red so perfect it might as well be copyrighted, and an idea of glamour that refuses to apologise for being beautiful.

Born in 1932 in Voghera, a small town in northern Italy, Valentino seemed destined for refinement long before he ever held a sketchbook. While other children played, he noticed seams. While others dreamed of adventure, he dreamed of elegance. Paris called early, and he answered – studying at the *École des Beaux-Arts* and apprenticing under couture legends. This mattered. Valentino didn't just *learn* fashion; he absorbed its grammar, its etiquette, its discipline. He learned that glamour, when done properly, is not loud – it's precise.



By 1960, he returned to Rome and opened his own atelier. This was not the brash arrival of a rebel designer; it was the confident step of a man who knew exactly who he was. The Valentino woman emerged fully formed: poised, aristocratic, impeccably dressed, and very much aware of her own power. When Jacqueline Kennedy chose him for her wedding dress to Aristotle Onassis, the fashion world took note. When Hollywood royalty followed, the message was clear: Valentino dressed women not for trends, but for history.



And then there was the red.

"Valentino Red" is not just a colour; it is a cultural artifact. Inspired, he said, by the reds he saw in opera houses and on women in the streets of Barcelona, it became his signature – and eventually his shorthand. See the red, think Valentino. Few designers have managed that level of instant recognition without logos plastered everywhere. His branding was subtler, smarter, and infinitely more enduring.

His career unfolded like a perfectly paced opera: decades of couture excellence, global expansion, and unwavering commitment to beauty. While fashion zigzagged through minimalism, deconstruction, and irony, Valentino stood firm. He believed in romance. He believed in luxury. He believed a dress should make a woman feel extraordinary – not challenged, not confused, not conceptualised.

When he retired in 2008, his farewell couture show was less a goodbye and more a coronation. The industry stood, applauded, and collectively admitted what it already knew: this was the end of an era.

Valentino Garavani's legacy is not just in garments preserved in museums or worn on red carpets. It lives in the idea that elegance still matters. That craftsmanship is not outdated. That beauty, when pursued sincerely and executed flawlessly, never goes out of style. In a world increasingly obsessed with speed, irony, and disruption, Valentino remains gloriously, stubbornly timeless. And honestly? Fashion could use more of that. 🍷



THE RITZ PARIS

A Legacy of timeless elegance



Where history, haute society, and refined luxury have defined the art of living since 1898



Few hotels carry the myth and magnetism of the Ritz Paris – a place where history doesn't just linger, it lives elegantly in every corridor.

Opened in 1898 by visionary hotelier César Ritz, the Ritz redefined luxury at the turn of the 20th century. It was among the first hotels in Europe to offer electricity, private bathrooms, and telephones in every room – features that were revolutionary at the time and set a new global standard for hospitality. But beyond innovation, it cultivated something more elusive: an atmosphere of effortless refinement.

The Ritz quickly became a sanctuary for royalty, artists, and cultural icons. Coco Chanel made it her long-term residence, embodying its spirit of understated elegance, while Ernest Hemingway famously claimed to have “liberated” its bar at the end of World War II – today immortalised as the Hemingway Bar.

Its significance lies not only in its opulence, but in its role as a stage for history, creativity, and high society. Wars, revolutions, and cultural movements have come and gone, yet the Ritz Paris has remained a constant – an enduring symbol of Parisian glamour and the art of living well.

To stay at the Ritz is not merely to book a room; it is to step into a legacy where luxury, history, and identity are inseparably entwined. 🏨

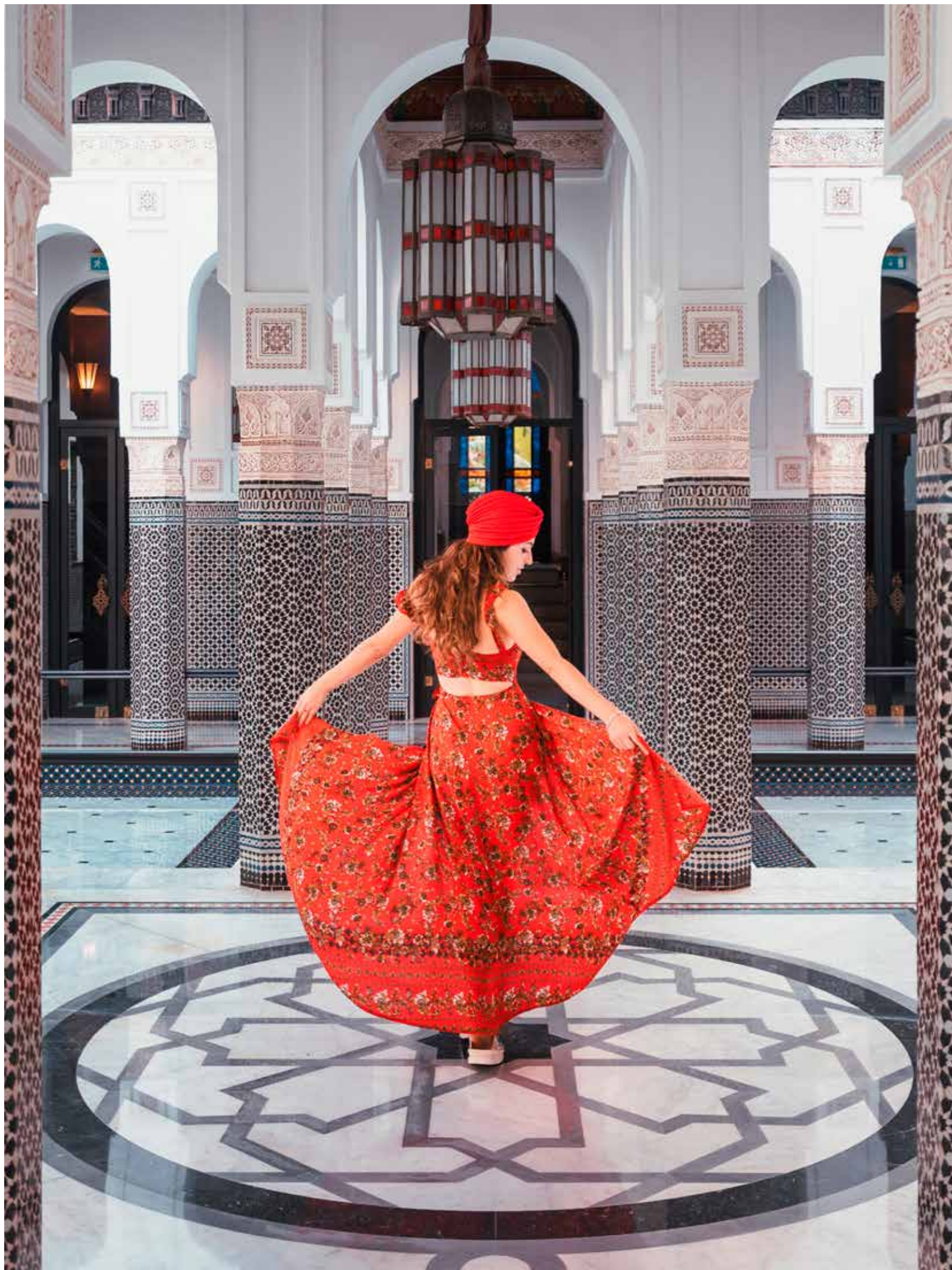

LA MAMOUNIA

The soul of Moroccan grandeur



Few places capture the soul of Moroccan luxury quite like the La Mamounia – a destination where heritage, artistry, and indulgence exist in perfect harmony. Set within the ancient city of Marrakech, La Mamounia stands on grounds once given as a wedding present to Prince Moulay Mamoun in the 18th century. The lush gardens that still surround the hotel are a living remnant of that royal past, offering a serene contrast to the vibrant energy of the Medina beyond its walls. When the hotel officially opened in 1923, it quickly became a beacon of refined escape, blending traditional Moroccan craftsmanship – zellige tilework, carved cedarwood, and intricate plaster – with the comforts of modern luxury. Over the decades, it has welcomed a remarkable roster of guests, from Winston Churchill, who famously painted its gardens, to global cultural figures seeking both privacy and inspiration. La Mamounia's significance lies in its ability to preserve and elevate Moroccan identity while setting an international benchmark for hospitality. It is not merely a hotel, but a sensory journey – where scent, texture, colour, and light come together to tell a story of place and tradition. To experience La Mamounia is to step into a world where time slows, beauty is ritualised, and every detail reflects a deep reverence for culture and craftsmanship. 🇲🇦



Photo: Alex Oelofse

PEERUTIN KAROL

CONTEMPORARY & TIMELESS

Peerutin Karol Architects is a Cape Town-based design studio defined by clarity, precision, and enduring architectural expression. Running for almost three decades under its current design leadership, the practice operates as a collaborative atelier where architecture, interiors, and urban design are approached as a cohesive discipline. Their work reflects a careful balance, resulting in spaces that are both refined and highly functional. Each project is guided by sensitivity to context, materiality, and proportion – key principles that underpin the firm’s architectural language.

This ethos is exemplified across a diverse residential portfolio, from the sculptural presence of the Clifton “Iron Man House” to the restrained elegance of this **Bishopscourt residence**. In Clifton, a bold interplay of concrete, glass, and organic form anchors the home within its dramatic coastal setting, creating an iconic architectural statement that remains deeply responsive to its natural context.

Bishopscourt embodies a quieter expression of sophistication. Set within a mature landscape, it is composed as a series of carefully articulated volumes, allowing light, scale, and material to define the spatial experience. Together, these projects illustrate the studio’s ability to balance expressive form with refinement, responding uniquely to site while maintaining a consistent architectural clarity.



Photo: Johan Jordaan



Iconic Iron Man House. A bold interplay of concrete, glass and organic form



Iconic Iron Man House, Clifton, Cape Town



Photo: Johan Jordaan

Bishopscourt residence. Light, scale and material set within a mature landscape.



Erbil House. A balance between enclosure and openness.

Erbil House, Iraq

SEAMLESS INTEGRATION

The residential work of Peerutin Karol Architects is defined by a disciplined approach to space, light, and material. Each project is conceived as a considered living environment – where architecture supports both function and experience, and where every element is carefully resolved.

Erbil House, Iraq, exemplifies this approach. The project explores the relationship between enclosure and openness, balancing solid architectural form with moments of transparency and connection to the landscape. Spaces unfold sequentially, creating a layered experience that is both dynamic and controlled.

Materiality plays a central role in defining the character of this residence. A restrained palette allows texture, light, and proportion to take precedence, reinforcing a sense of calm and permanence. The architecture is neither excessive nor ornamental; instead, it is deliberate – each gesture contributing to a cohesive whole.



Erbil House. An ongoing dialogue with the surrounding environment.

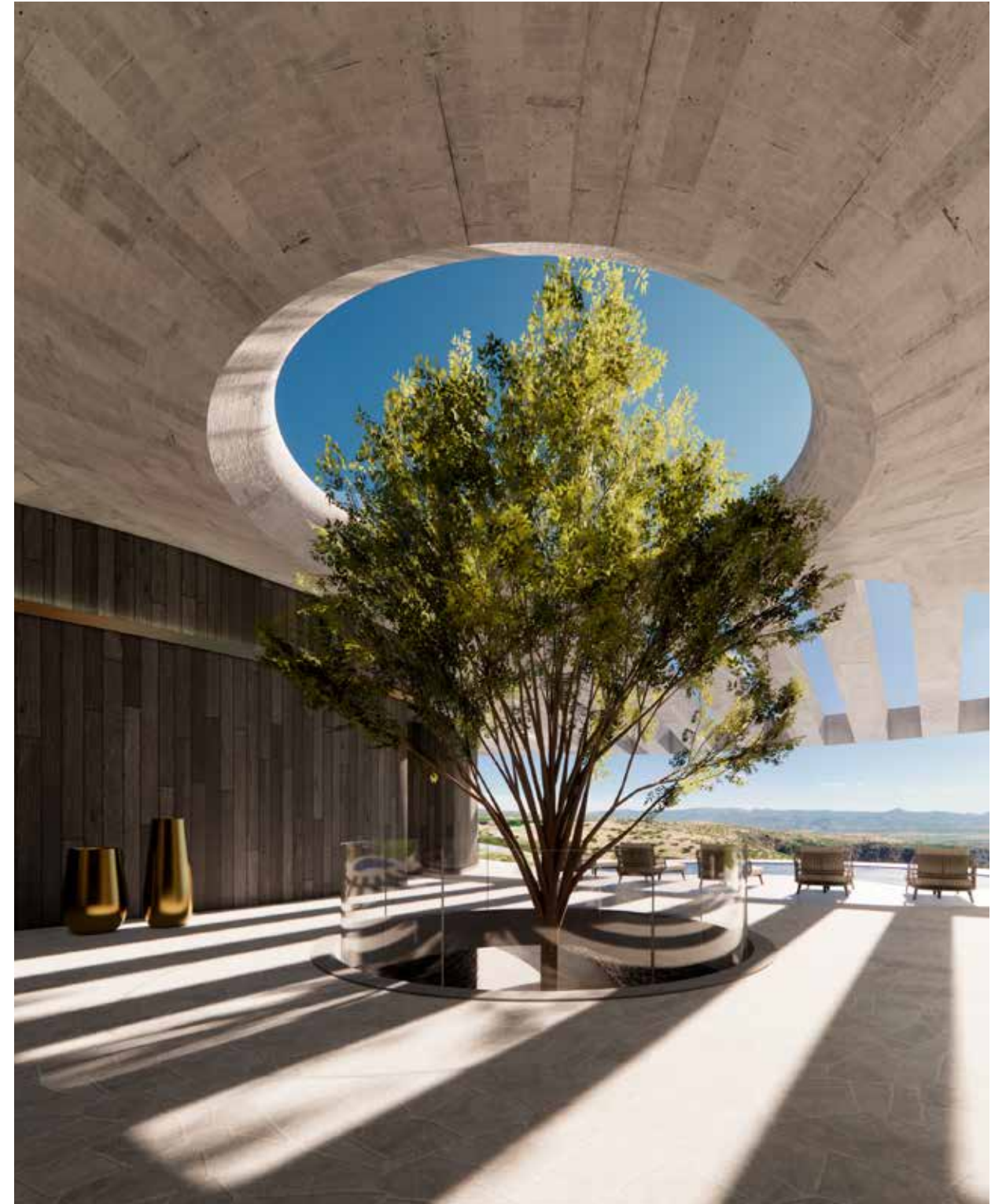

A creative experience of transparency and connection to the landscape.



Kashimbila Island Hotel

Ostia Island Hotel



Beyond individual buildings, the practice is actively engaged in large-scale master-planning, extending its design thinking into the broader urban context. These projects address movement, density, and public space with precision - resulting in cohesive, future-focused environments.

ACROSS SCALES & GEOGRAPHIES

Commercially robust and architecturally enduring

Peerutin Karol Architects brings the same clarity and discipline to its commercial work, delivering projects that are both strategically driven and architecturally resolved.

The studio's portfolio spans mixed-use developments, hospitality, retail environments, and corporate spaces – each shaped by a strong understanding of urban dynamics and user experience.

This approach is evident in projects such as **Radisson RED** hotel in Cape Town's *V&A Silo District*, developed in collaboration with Design Network, where contemporary hospitality design is paired with a refined architectural language to create spaces that are both functional and distinctive.

Similarly, developments like Kashimbila Island Hotel and Ostia Island in Lagos, reflect the studio's ability to engage with large-scale, complex briefs – balancing commercial performance with spatial quality and contextual responsiveness with spatial quality and contextual responsiveness.

Each project is approached with an emphasis on clarity, efficiency, and long-term value. Complex programmes are distilled into legible architectural forms, ensuring that buildings not only perform effectively but also contribute meaningfully to their surroundings.



Ostia Island



Radisson Red Hotel, Cape Town

ARCHITECTURE & BEYOND

FROM LOUD TO LIGHT

THE COLOUR THAT DEFINES THE MOMENT

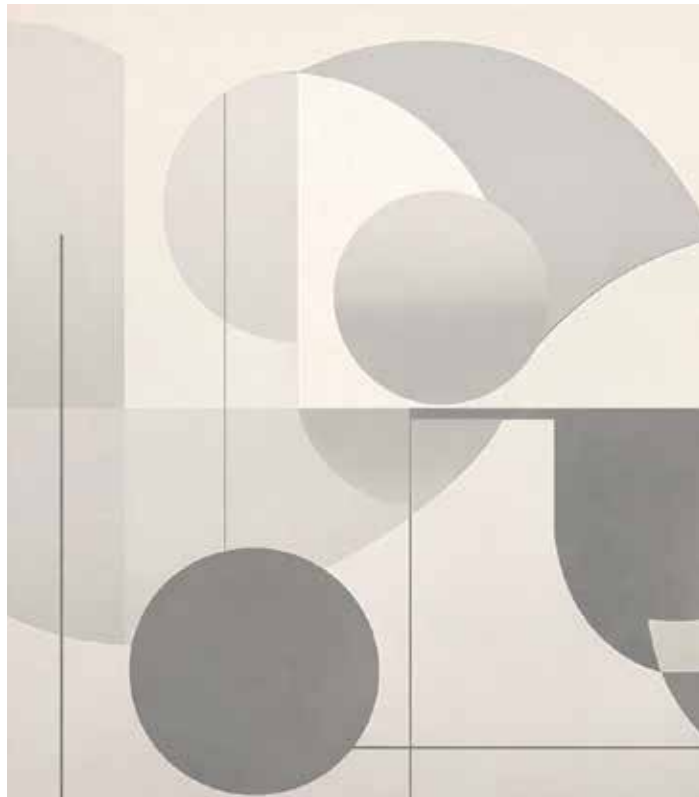

A year of creativity and colour conversations

Cloud Dancer dreams. Less noise, more nuance

Every year, colour experts and trend forecasters around the world spotlight a hue (or several) that captures the spirit of the moment. For 2026, the dominant narrative in this ever-evolving conversation is one of calm, and creative openness, a notable shift from bold statements toward thoughtful simplicity.

At the forefront of this shift is Pantone's Colour of the Year 2026 "Cloud Dancer" – a soft, airy off-white that Pantone describes as "a whisper of tranquillity and peace in a noisy world." This marks the first time Pantone has selected a white-leaning shade since launching the Colour of the Year initiative in 1999. Its balanced, ethereal presence is meant to offer clarity, calm and a fresh start amid societal transformation, digital fatigue, and overstimulation. The choice reflects a collective desire for spaces – both physical and emotional – that feel open, uncluttered, and conducive to creative thinking.

Cloud Dancer's appeal lies not only in its neutrality but in its versatility. It functions as a foundational backdrop that harmonizes with a broad spectrum of colours – from powdery pastels and breezy blues to richer hues like plums and deep browns – giving designers a flexible canvas for expression. Pantone even created six distinct palettes around Cloud Dancer to demonstrate how the shade can shift in character depending on its partners, whether in interiors, fashion, product design or branding.

But 2026's colour story isn't limited to one shade. Other influential voices in design and social platforms have highlighted complementary and alternative trends that show where the wider colour conversation is heading. For example, Pinterest's trend report highlights bold colours such as *Cool Blue*, *Wasabi*, *Plum Noir* and *Persimmon* as standout hues shaping everything from fashion to home décor. These shades suggest that while calm and clarity are central themes, there's also space for vibrant self-expression in the year ahead.

Meanwhile, retailers and design brands outside Pantone – reflect a complementary trend: injecting personality and warmth into everyday living spaces.

Together, these colour narratives show that 2026 will be a year of balance: one that embraces peace and simplicity without losing sight of boldness and individuality. Whether it's through serene whites that reset our visual minds or richer palettes that energise our environments, colour continues to reflect both cultural moods and personal aspirations in profound ways.



THINK LUXURY.

THINK PAINT.

THINK VERSUS.



Proud sponsor of 
www.versuspaint.co.za

Timeless dune

Versus Paint's refined interpretation of the universal khaki movement



As the global design community gravitates toward enduring neutrals, Versus Paint introduces Timeless Dune - a sophisticated khaki-toned hue inspired by nature, architectural restraint, and the quiet permanence of timeless material palettes.

The shift away from trend-driven colour is well underway. Across interiors and facades alike, earth tones have reasserted themselves as the language of considered design – grounded, versatile, and resistant to the passage of seasons. Timeless Dune is Versus Paint's contribution to this movement: a warm architectural neutral that sits poised between beige and khaki, evoking sunlit dunes and weathered stone in equal measure.

Where cooler greys can feel clinical and stark whites austere, khaki-based neutrals offer something rarer – stability with warmth. They recede where needed, allowing texture, material, and form to lead, while lending any space an innate sense of harmony. Versus developed Timeless Dune specifically to complement the palette of modern luxury architecture: natural timber, brushed metals, raw stone, linen, and wool. The result is a shade that enhances rather than competes.

Its versatility is perhaps its greatest strength. Timeless Dune moves with equal confidence through spare minimalist interiors and richly layered rooms filled with antiques and curated objects, making it as practical as it is refined.

“Timeless Dune reflects a shift towards colour palettes that prioritise longevity, natural warmth, and architectural balance.”

LIGHT & FLUIDITY

REFINED & RELAXED



Rachel Fayman Design is a boutique luxury interior design studio based in Coral Gables, serving clients across Miami and beyond.

Rachel began her career in New York City before moving to London, where she spent years working at the highest level of residential design. Now rooted in South Florida, she brings that international foundation to every project – a meticulous eye, a layered sensibility, and a deep respect for how people live.

In recent years, Miami's residential landscape has evolved into one of the most dynamic luxury markets globally. An influx of international buyers and high-net-worth individuals has driven record-breaking sales and a new standard of design, with ultra-prime properties commanding unprecedented prices and architectural ambition. This surge has brought a heightened appreciation for bespoke interiors – spaces that balance statement-making design with liveability, discretion, and craftsmanship. For designers, it presents an opportunity to work at a level where detail, materiality, and narrative are as important as scale.

RFD takes on a select number of residential projects each year. From full renovations to single-room transformations, every engagement is hands-on, personal, and built around the way each client lives. From concept through installation – space planning, custom furniture and millwork, finishes, lighting, art curation, and full project management.

Miami has added a new dimension to Rachel's work – a sense of ease, light, and fluidity that complements her more structured, European-influenced approach. The interplay between indoor and outdoor living, the richness of natural materials, and the vibrancy of the surrounding culture informs a style that feels both refined and relaxed.

Over the past two decades, Miami has transformed into a global capital of design and art, driven by events like Art Basel Miami Beach and the rapid evolution of neighbourhoods such as Wynwood Walls and the Miami Design District. Once known primarily for its beaches and nightlife, the city now attracts leading artists, designers, and collectors from around the world, blending cutting-edge architecture, vibrant street art, and high-end galleries into a dynamic cultural scene that rivals traditional art hubs like New York and Paris.



RACHEL FAYMAN
DESIGN



INDIGENUS

Aarde, by Sebastian Herkner

Planters for indoors and outdoors
indigenus.co.za

South African Lighting Experts Claim **Top Global Honour: 4 Lit Design Awards** and **Best Lighting Product Design** at 2025 LIT Awards.

Cape Town-based One to One by Martin Döller achieves international recognition, showcasing South African experiential lighting design on the world stage.



Cape Town, South Africa – In a landmark achievement for South African design, One to One by Martin Döller has been awarded Best Lighting Product Design at the prestigious 2025 LIT Lighting Design Awards. The winning piece, Amphora, created for an ARCC project in Argentina, triumphed over entries from leading designers and manufacturers worldwide across more than 40 product categories.



The LIT Lighting Design Awards represents one of the most competitive international platforms in the lighting design industry, with entries spanning everything from high end residential projects to villa destinations. Amphora's selection as the top product design honour validates South Africa's growing influence in the global design community and demonstrates that One to One's experiential lighting philosophy – resonates at the highest level.

"This award-winning light design is the result of a thoughtful collaboration with One to One by Martin Döller, evolving through several projects and iterations. Its amphora-inspired form delivers a concealed light source while embracing materiality that celebrates natural imperfection over polished perfection. This partnership reflects a shared commitment to craftsmanship and innovation, culminating in a piece that honours the transformative power of light." – Amy King, ARCC Associate.



The Elegance of Quiet Contrast

Where soft whites are deepened by rich woods, burnished copper, gold objects, and clear glass to compose a new language of interior balance



Gold abstract organic object with holes on black bg 3d render

Soft whites arrive as a whisper rather than a statement – evoking calm, clarity, and a much-needed sense of pause. They reflect a broader cultural desire for tranquillity, offering interiors that feel light, breathable, and emotionally restorative. Yet, this gentle palette does not exist in isolation. Its true strength emerges in contrast.

Alongside this airy minimalism, a parallel movement continues to gain momentum: the return of depth. Dark woods and rich wall panelling are being used with precision, grounding spaces and lending architectural weight. These elements prevent pale interiors from drifting into sterility, instead anchoring them in warmth and intention.

Copper accents further complicate – and enrich – the story. Their subtle sheen introduces a quiet luxury, catching light without overpowering it. In furniture, fabric choices echo this balance: tactile, muted, and layered, bridging the gap between softness and structure.

Beyond materials and finishes, it is the considered placement of objects that ultimately defines a space. Decorative pieces are no longer incidental; they are curatorial. Each object – whether sculptural, functional, or purely ornamental – carries visual weight, contributing to rhythm, contrast, and narrative. In this context, metals such as copper and gold lend warmth and refinement, while their reflective qualities animate the surrounding palette.



Golden metal glass on grey background 3d render

Perhaps the most understated yet powerful unifier is clear, chiselled glass in all its forms. Whether faceted, etched, or sculpted, it acts as a connector – capturing and refracting light, softening transitions between elements, and drawing together disparate materials. Its presence is both subtle and transformative, bridging light and dark, matte and sheen, solidity and transparency.

In this interplay, interiors feel neither stark nor heavy but thoughtfully composed. The message is not about choosing between light and dark, but about mastering their dialogue. Tranquillity, it seems, is most compelling when it has something deeper – and more deliberate – to rest against.



AI generated

Where folk dances with the future

Maryna Pupcha on Emotion, Memory, and Playful Ukrainian Design

Maryna Pupcha is a Ukrainian designer whose work exists at the intersection of collectible design, contemporary craft, and emotional storytelling. Through rugs, textiles, and interior objects, she creates limited-edition pieces that balance craftsmanship with humour, softness with structure, and tradition with a distinctly contemporary expression.

At the core of Pupcha's practice is the belief that design should **carry emotion, memory, and a sense of play**. Her objects are conceived not as static decor, but as active participants in an interior – pieces that subtly shape atmosphere, invite interaction, and reveal character over time. Maryna is drawn to interiors that feel cinematic, layered, and personal, where design operates as a quiet narrative rather than a decorative statement.

Pupcha does not follow trends or mass production. Each object is produced in limited editions – often no more than five to 10 pieces – or created as a one-of-a-kind work. This intentional scale allows space for experimentation, imperfection, and individuality. For Maryna, true luxury lies not in perfection, but in intention: understanding why an object exists, how it was made, and what emotional presence it brings into a space.

Creative language and inspiration

Maryna's primary source of inspiration is **Ukrainian folk culture**, reinterpreted through a contemporary **ethno-boho-funk** lens. Her visual language is equally informed by cinema, music, funk culture, and the subtle humour found in everyday life. These influences converge in works that feel both familiar and unexpected – rooted in cultural memory while confidently modern.

Contrast plays a central role in her practice. Rugs become sculptural objects, textile elements migrate into furniture, and traditional symbols appear in playful, unconventional contexts. Humour is an essential tool in this process. Rather than diminishing seriousness, it creates intimacy, lowers barriers, and invites a more human connection with the object.





Every piece carries a story, but never in a didactic or solemn way. Pupcha's narratives are warm, ironic, and approachable – meant to be lived with, touched, and enjoyed, rather than admired from a distance.

The Duck Butt room divider

Among her most recognisable works is the **Duck Butt room divider** – a sculptural piece crafted from natural ash wood with soft carpet inserts. Balancing elegance with irony, the divider gently disrupts expectations of functional design. It does not simply divide space; it softens it, adds personality, and serves as a reminder that sophistication and humour can coexist. The piece encapsulates Maryna's belief that interiors need not take themselves too seriously to be meaningful.

Journey and values

A self-taught designer and artist, Maryna has been immersed in creativity since early childhood. Art was never a strategic career choice – it was her natural way of perceiving and understanding the world.

Her professional journey has been intentionally non-linear, spanning jewelry art, the auction world, and even aviation. These diverse experiences shaped her sense of discipline, form, and narrative, reinforcing her belief that creativity thrives when it remains curious, open, and playful.



At the heart of her practice are authenticity, craftsmanship, emotional resonance, and joy. For Maryna Pupcha, design is not about flawless surfaces or intellectual rigidity. It is about character, warmth, and creating spaces where people feel at ease – often with a smile.

Representation and recognition

Maryna Pupcha's work is represented by **Galerie Sana Moreau** (Paris), with main collections based in Kyiv, Ukraine. Her pieces have been featured internationally, including at **Maison & Object** where her work has been highlighted within the context of contemporary Ukrainian neo-folkloric design.

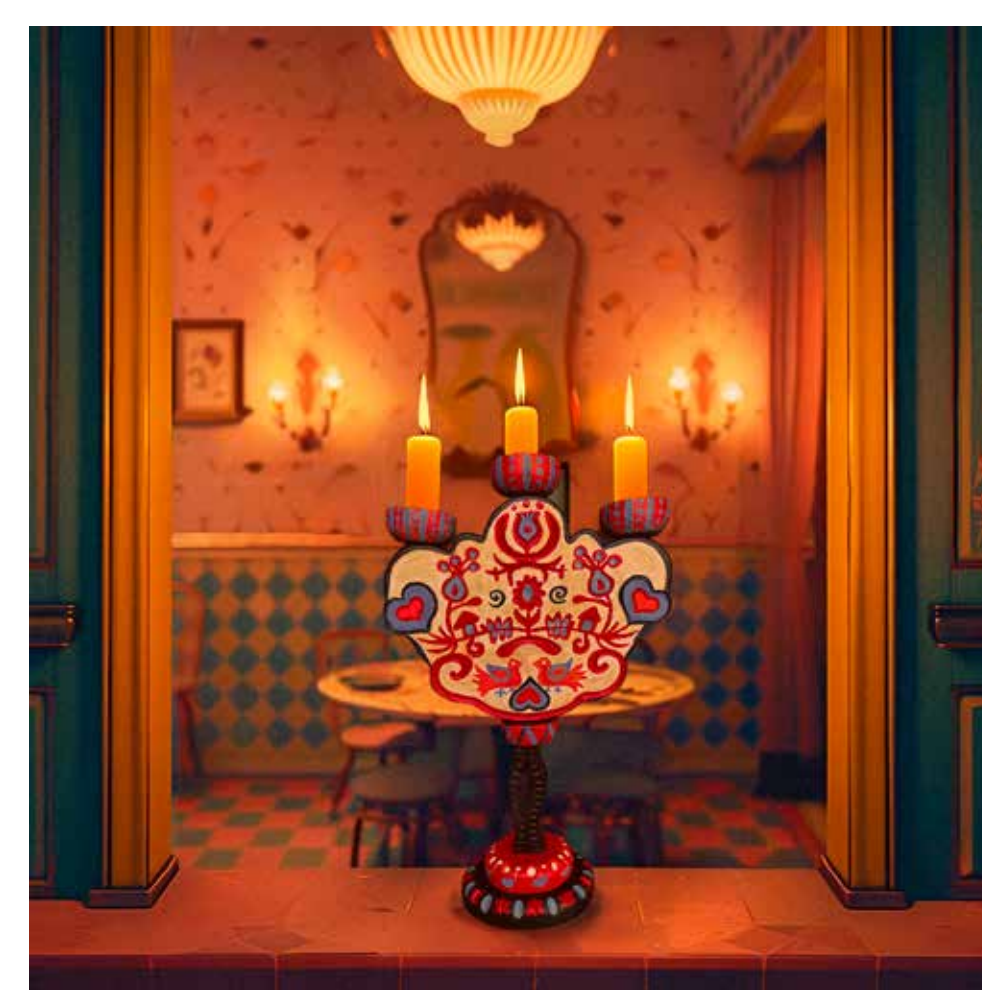



Q You describe the divider as something that does more than just separate space. Can you expand on that idea?

Maryna Pupcha: Yes, absolutely. While it functions as a divider, its role is softer than that. It creates a sense of intimacy without rigidity. It softens the environment, making it feel warmer and a bit less predictable. I like when design elements introduce a quiet sense of surprise – they make a space feel more personal and less controlled.

Q How important is emotional response in your work? Do you consciously design for moments like a smile or a second glance?

Maryna Pupcha: Very much so. I think those small emotional reactions are incredibly powerful. A slight smile, a moment of curiosity – these are subtle, but they change how we experience a space. I don't want design to feel distant or overly perfect; I want it to feel approachable and alive.

Q This piece clearly resonated with us, and we're not alone in that. How does it feel to see your work connect with audiences in this way?

Maryna Pupcha: It means a lot. This piece reflects an important part of how I think about design, so it's always special when that way of thinking is understood and appreciated. It reassures me that there's space for softness, humour, and individuality in contemporary interiors.

Maryna Pupcha's work reminds us that design doesn't have to choose between beauty and personality – it can quietly hold both, inviting us to experience spaces with a little more warmth, curiosity, and joy. 🐥



In conversation with LUSX Magazine

We spoke with Maryna about one of her most distinctive works – the “Duck Butt” room divider. Blending humour, craftsmanship, and subtle emotional design, Pupcha invites us into a world where objects don't just occupy space – they quietly transform it.

Q Your “Duck Butt” room divider has such a memorable and unexpected name. Can you tell us how this idea first came to you?

Maryna Pupcha: It began as a small internal joke. I was reflecting on how interiors can sometimes feel overly serious – too composed, almost cautious about showing personality. I wanted to introduce something that could gently interrupt that atmosphere without disrupting the overall harmony of the space.

Q The piece carries a playful visual language, yet it still feels refined. How did you approach balancing humour with elegance?

Maryna Pupcha: The pattern is intentionally a little absurd and playful, inspired by those fleeting moments when ducks dive underwater and you're left

with the charming image of their little tails sticking up. It's something that makes you pause, look again, and maybe smile. At the same time, I grounded the piece in calm, natural materials – ash wood paired with soft textile inserts – so there's always a dialogue between sophistication and lightness.

Q There seems to be a deeper philosophy behind the work beyond its visual charm. What does this piece represent for you as a designer?

Maryna Pupcha: For me, it's not really about ducks at all. It's about allowing objects to have character – to feel alive, even slightly human. I'm interested in how design can subtly shift the emotional tone of a space, not through scale or bold statements, but through small, unexpected details.

CHOOSING THE PERFECT PRIVATE JET

**The thrill of
private jet travel
– a first-time
experience**

Hiring a private jet for the first time can be a thrilling experience, offering a sense of luxury, freedom, and exclusivity. Here's what you might expect:

Unparalleled convenience

Stepping into a private jet, you're immediately struck by the personalised service and attention to detail. From the moment you board, you're treated like royalty, with every need catered to by a dedicated crew.

Luxurious ambiance

The interior of a private jet is designed to provide ultimate comfort and relaxation. Plush seating, gourmet catering, and state-of-the-art entertainment systems create an ambiance that's hard to match.

Flexibility and freedom

Private jet travel offers unparalleled flexibility. You can create your own schedule, fly to destinations that suit your needs, and enjoy the freedom to travel without the constraints of commercial airlines.

Sense of exclusivity

Hiring a private jet gives you access to exclusive airports and terminals, often closer to your destination. You'll avoid the crowds and long lines associated with commercial air travel, making your journey feel more private and personalised.

First-time jitters

As a first-time private jet traveller, you might feel a mix of excitement and nervousness. But as you settle in and experience the luxury and convenience, you'll likely feel like you're in good hands.





Find your next star.

Mercedes-Benz Bassonia
011 405 2880

Mercedes-Benz Bedfordview
011 677 1000

Mercedes-Benz JHB North
011 460 8600

Mercedes-Benz Polokwane
015 299 9500

Mercedes-Benz Rustenburg
014 537 6700

Mercedes-Benz Sandton
011 263 6500

Mercedes-Benz Tzaneen
015 307 5020

Mercedes-Benz West Rand
011 471 7900

Motus Mercedes-Benz
066 165 7618



A new standard of travel

Once you've experienced private jet travel, you might find it hard to go back to commercial airlines. The level of service, comfort, and flexibility is unmatched, making it a truly unforgettable experience.

Whether you're travelling for business or pleasure, hiring a private jet for the first time is an experience you'll cherish. The memories, the luxury, and the convenience will leave a lasting impression, making you wonder how you ever settled for anything less.

A guide to different types and selection tips

Private jets offer unparalleled luxury, flexibility, and convenience for travellers. With various types of private jets available, selecting the right one can be overwhelming. Let's explore the different types of private jets and provide tips on how to make the best possible selection for your needs.

Light jets

Ideal for short trips, light jets seat 4-8 passengers and offer excellent fuel efficiency. Examples include the Citation Mustang and Phenom 100.

The 9 factors to consider when selecting a private jet

1. Consider the distance you'll be flying and the performance capabilities of the jet.
2. Determine the number of passengers you'll need to accommodate.
3. Think about the level of luxury and amenities you require, such as screen, and entertainment systems.
4. Establish a budget
5. Level of customisation you need, such as interior design and bespoke features.
6. Compare features, performance, and costs.
7. Work with a reputable broker or manufacturer to gain expert advice and guidance.
8. Test-fly different jets to experience their performance and comfort firsthand.
9. Explore different ownership options, such as fractional ownership or jet cards, to find the best fit for your needs.

Midsize jets

Suitable for medium-haul flights, midsize jets seat 6-9 passengers and provide a balance of comfort and performance. Examples include the Citation XLS and Hawker 900XP.

Super midsize jets

Offering enhanced range and comfort, super midsize jets seat 8-10 passengers and are perfect for longer flights. Examples include the Citation X+ and Challenger 300.

Large jets

Designed for long-haul flights, large jets seat 10-19 passengers and offer luxurious amenities. Examples include the Gulfstream G650 and Bombardier Global 6000.

Ultra long-range jets

Capable of flying non-stop for extended periods, ultra long-range jets offer unparalleled comfort and range. Examples include the Gulfstream G700 and Bombardier Global 7500. ✈️





The Evolution of African Wealth

From the spirit of Ubuntu to the strength of the Nguni, African wealth has always told a story.

MetCon honours this legacy with modern expressions of value – **Ubuntu Rounds, Minted Bars, Nguni Cows & Bulls, and Cowries** – cast in precious metals, from the heart of our land.

Ethically Refined. Locally Crafted. Authentically African.

Where African Heritage Meets Modern Investment. Visit MetCon.co.za

MC.

SEZ: +27 (0) 12 000 4440 | CPT: +27 (0) 21 510 0770 | info@MetCon.co.za | MetCon.co.za



The wild world of digital gold

Navigating crypto's frontier with Bitcoin

Bitcoin is a decentralised digital currency that was introduced in 2008. It officially launched in January 2009. Unlike traditional currencies issued by governments, Bitcoin operates on

a peer-to-peer network, allowing users to send and receive payments without intermediaries like banks.

Bitcoin's underlying technology, blockchain, is a distributed ledger that records all transactions securely and transparently. This innovation solved the long-standing "double-spending problem" in digital money. Bitcoin gained wider attention in 2010 when a programmer paid 10,000 BTC for two pizzas – an event now

famously known as "Bitcoin Pizza Day." Over time, Bitcoin has experienced dramatic price fluctuations. From being virtually worthless in its early days, it reached major milestones, including surpassing \$1,000 in 2013 and later climbing above \$60,000 in 2021. These price swings have made it both a speculative asset and a store of value often compared to gold.

Interesting facts make Bitcoin unique:

- There will only ever be 21 million bitcoins in existence, making it inherently scarce.
- Transactions are pseudonymous, meaning they are recorded publicly but not directly tied to real-world identities.
- Bitcoin mining – the process of validating transactions – consumes significant energy, sparking global debates about sustainability. 🌱

Today, Bitcoin remains the most well-known cryptocurrency, influencing thousands of other digital currencies and continuing to shape the future of finance.

- Bitcoin is the first and most well-known cryptocurrency. It was created in 2009 and is often seen as "digital gold." Its main purpose is to act as a store of value and a decentralised alternative to traditional money.
- Cryptocurrency (Crypto) is a broad term that includes all digital currencies that use cryptography and blockchain technology. Bitcoin is just one of thousands. Examples of other cryptocurrencies include:
 - Ethereum – supports smart contracts and apps
 - Ripple (XRP) – focused on fast bank transfers
 - Solana – known for speed and low fees



ZANNIER
SONOP
FACTSHEET

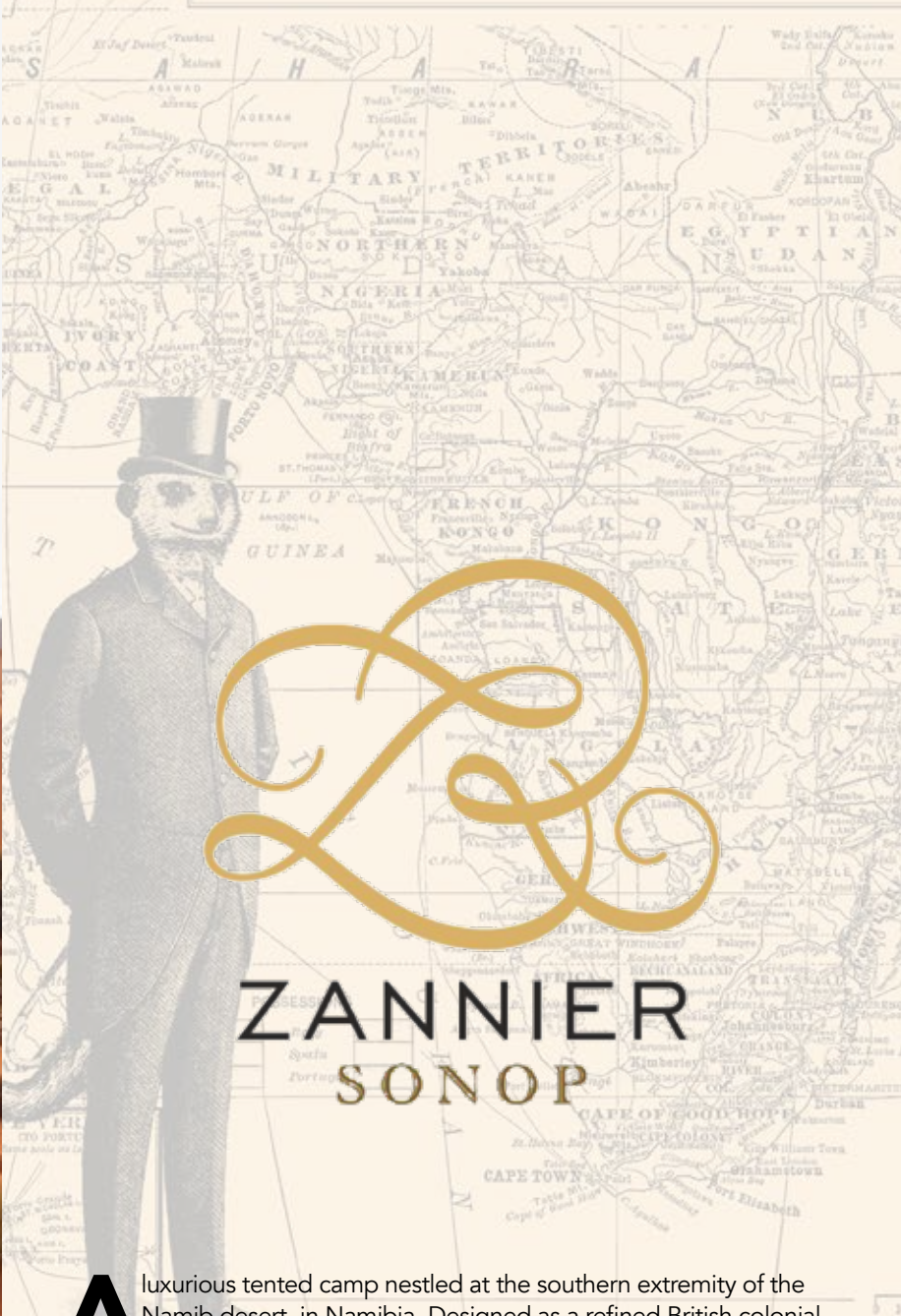

ZANNIER
SONOP

A luxurious tented camp nestled at the southern extremity of the Namib desert, in Namibia. Designed as a refined British colonial experience from the 1920's, this out-of-the-ordinary lodge offers a perfect retreat in a stunning panoramic desert landscape.

Constructed on top of boulders, the 10 spacious tents aim to offer a unique journey through time. Richly furnished with antiques made of fine materials, colourful carpets and precious wood, they are an invitation to live the life of yesteryear's wealthy explorers.

The sophistication of the lodge contrasts with the simplicity of the endless surroundings. Everything is orientated towards the desert's richness: all views are awe-inspiring and a large list of adventures allow guests to admire the desert's genuine beauty at leisure.

For ultimate comfort, Zannier Sonop offers a spa, fitness centre and heated outdoor infinity pool, all facing the desert's vastness.



BYGONE ERA RELIVED

Every evening guests are invited to enjoy an opulent gastronomic experience, where silverware and candelabras set the mood, enhanced by black-tie service. The cocktail and cigar lounge offers a subtle reflection of the splendour of colonial interiors.



All tents offer roll-up canvas openings with panoramic views, a large bedroom and a separate bathroom with double sink and a large bathtub combined with a rain shower. The bedroom features a four-poster bed with king-size mattress, a distinct living area with comfortable armchairs, a desk and a telescope to view the distant surroundings. All king-size beds can be made into Hollywood Twin. Every tent at Zannier Sonop is equipped with free Wi-Fi, a Nespresso machine, kettle, safe, air-conditioning system, heating and a docking station. The lodge's energy supply relies entirely on solar panels.



CULINARY EXCELLENCE

À-la-carte breakfast is served daily at the restaurant. Lunch is served every day. A daily traditional afternoon tea is served in the lounge or on the lounge terrace. An all-inclusive elegant gala dinner with silver service served around a communal dining table every evening in the restaurant. The pool bar, overlooking the desert, welcomes guests throughout the day for a drink or a cocktail. The Cigar & Cocktail Lounge serves a selection of cocktails and exclusive spirits in a convivial atmosphere, where a billiard table takes the centre stage.

OUTDOOR EXCURSIONS

Breathtaking outdoor excursions are offered at Zannier Sonop within the 5,600 ha of the private reserve, where oryxes, brown hyenas, rabbits, foxes, jackals, kudus and leopards roam free. This includes exploring the desert by foot or riding horses from the lodge's own stables. Electric mountain bikes and comfortable game viewers will allow guests to discover the light blue distant mountains. Other made-to-measure excursions will be organised on demand, such as hot air balloons, hiking or dinners in the wild.



Access by plane Own air strip, allows guests to access the lodge from any African airport with small planes. The nearest international airport is in Windhoek.



Access by road The lodge is located 500km from Windhoek (5 hours) by the road.



Transfers Zannier Sonop's concierge team is pleased to organise transfers to Sossusvlei, as well as to or from the airports (both international and domestic).

WHERE

ART

INSURANCE MEET

Bespoke insurance solutions for collections of fine art, jewellery, wine, whiskey and other investment assets.

Think about it.

Insurance is typically designed to protect assets that depreciate over time yet your irreplaceable art and collectables are appreciating in value.

Protecting them effectively - against repair, restoration or theft - requires cover that is as unique as the investment assets themselves.

Regardless of our preferences for Banksy or Boticelli, that's something we can all appreciate, isn't it?

itoo.co.za

ITOO Special Risks is a specialty underwriter with unique product offerings such as Classic car insurance, Personal Cyber insurance and Kidnap & Ransom cover.



artyli
Gallery

Contemporary African Art in the Heart of Sandton

Located in Nelson Mandela Square Mall, Artyli Gallery presents a curated selection of contemporary African art, with a focus on emerging and mid-career artists gaining international recognition.

Each work carries a distinct narrative, bringing presence, depth, and cultural resonance into contemporary spaces.

“Each work is more than an object, it is a narrative, carrying the depth, identity, and evolving voice of contemporary Africa into the spaces we inhabit.” – Karen Cullinan, Founder and Director, Artyli Gallery

Alongside its dynamic exhibition programme, the gallery features works by renowned South African sculptor Anton Smit, as well as guided tours, offering a unique and immersive experience. Artyli Gallery participates in both local and international art fairs, positioning its artists within a global context.

The gallery offers bespoke services including art advisory, private curation, custom framing, and secure worldwide shipping.



For private viewings and enquiries:
Artyli Gallery
Nelson Mandela Square Mall, Sandton
WhatsApp: +27 78 648 8221
Website: www.artyli.com



Earth 2.0 XL stoneware bowl width 62cm; 17cm high

WHERE EARTH, IMAGINATION AND FORM CONVERGE

Johan Swart Ceramics

In the quiet, vineyard-lined town of Stellenbosch, clay becomes something far more than material in the hands of Johan Swart. It becomes narrative, memory, and invention – an evolving dialogue between earth and imagination.

Johan at work in his Stellenbosch studio

Swart's journey into ceramics began in 1988 at the Free State University of Technology, where he studied ceramic design. What followed was not a straight line into authorship, but a richly layered career shaped by teaching, mentorship, and community engagement. Before establishing his full-time studio in 2005, he spent years as a ceramic instructor and art teacher, nurturing creativity in others while refining his own voice.

That voice has since resonated far beyond South Africa's borders. As a long-standing member of Ceramics SA, Swart has exhibited widely, both locally and internationally, and more recently, his work has earned him nomination and official membership to the prestigious International Academy of Ceramics – an acknowledgment reserved for artists shaping the global conversation in clay.



Makhulu Blue, white stoneware, 81cm high

THE LANGUAGE OF CLAY

At the heart of Swart's practice lies a restless curiosity. His work challenges traditional notions of functionality, blurring the boundaries between object and artwork. Vessels are no longer defined by their utility alone; instead, they exist as sculptural presences – pieces that invite both contemplation and touch. His approach is deeply experimental. Surfaces are carved, altered, and layered; forms move between symmetry and disruption. There is a deliberate tension in his work – a balance between control and spontaneity – that gives each piece its own quiet energy.

Swart speaks through texture as much as form. His ceramics seem to hold time within them, as though shaped not only by the artist's hand but by elemental forces – fire, erosion, and pressure.

SCULPTING THE FUTURE: FORM MEETS FANTASY

While grounded in tradition, Swart's work is equally forward-looking. Pieces such as Makhulu Blue reinterpret classical forms like the amphora through a contemporary African lens – its structured base rising into a textured, almost unruly rim, finished in a vivid blue glaze that commands attention.



Ndalo vases, white stoneware clay 27cm high; 30cm high; 31cm high

NDALO: AN ODE TO AFRICA

Among his most evocative bodies of work is the Ndalo series – a collection of contemporary vases deeply rooted in African inspiration. Drawing from the continent's textures, patterns, colours, and landscapes, these pieces are both grounded and expressive.

Here, Swart masterfully balances opposing forces: symmetry against organic flow, refinement against rawness. Certain elements are meticulously

controlled, while others are allowed to emerge naturally during the firing process. The result is a series of vessels that feel at once ancient and modern.

Notably, the Ndalo vases reject conventional function. They are not designed to carry water or store grain, but to embody beauty itself – to occupy space with presence and to elevate their surroundings. The name "Ndalo," translating to "nature" or "beautiful creation," speaks directly to this intention.



Chronos Engine, white stoneware clay 50cm high

A LIVING MEDIUM

Johan Swart's ceramics remind us that clay is not static. It is alive with possibility. Through craftsmanship, experimentation, and a willingness to push boundaries, he transforms earth into objects that are at once tactile, visual, and deeply evocative.

In a world increasingly defined by the digital and the disposable, his work offers something grounding: a return to material, to process, and to the enduring beauty of things made by hand. 🏠

In contrast, works like Chronos Engine venture boldly into the realm of speculative design. These vessels, with their carved surfaces and industrial aesthetic, evoke imagined machines and ancient artifacts from alternate futures. Clay is transformed into something resembling weathered metal – objects that feel excavated rather than made.



The Wall Sculptural Vessel, mixed stoneware clays 20cm high

BEYOND THE STUDIO

Integral to Swart's practice is a commitment to education and community. Through workshops and teaching, he continues to share his knowledge, inspiring emerging artists and cultivating a deeper appreciation for ceramics as a contemporary art form. This spirit of generosity is mirrored in his work itself – pieces that invite interaction, reflection, and emotional connection.



The Royal
LIVINGSTONE
 VICTORIA FALLS ZAMBIA HOTEL
 BY ANANTARA

Set on the banks of the mighty Zambezi River, the hotel is highly sought after for its UNESCO World Heritage location, fine dining, adventurous outdoor activities and warm hospitality. Bask in graceful safari style only steps from one of the Seven Natural Wonders of the World. Sweeping Zambezi River and savannah views stretch from every veranda as you relax in elegance.

Wake up, head to the gym and catch sight of zebras wandering the hotel grounds. Raise a

glass at sunset to the marvellous Victoria Falls waterfall thundering to its depths. Surrender to relaxation with spa therapies under the shade of monkey trees on the banks of the river. Wine and dine or sip on local gins, while you lay in your riverside hammock. If you are looking for more adventure, go bungee jumping or take a tour to Livingstone Island.

Beautifully appointed interiors highlight gorgeous garden views and unsurpassed luxury. Sink into soft bedding dressed in the

finest linens. Laze on your private balcony watching free-roaming wildlife. Enjoy modern amenities and the attentive butler service for which Anantara is known.

Take in the incredible sunsets from Kubu deck or from the comfort of the Old Drift terrace. Each artistic feature is carefully chosen to reflect the heritage of the area and help you appreciate the destination. Unwind with hot tea and soak up the ambiance of this incredible location. 🐾





An intimate and luxurious retreat, Anantara Tented Camp Kafue River. This elegant, tented camp is designed in harmony with the local environment and offers 10 villas and three Horizon Terrace Suites for guests to unwind. Connect by river and rugged road with plains, waterways and wildlife that calls the park home from an elevated riverbank hideaway.

Kafue National Park is one of the largest national parks in Africa and covers vast unspoiled terrain home to an abundance of wildlife and bird species. The nearest major town is Lusaka, and the international airport is reachable in five hours by road.

Or begin your extraordinary safari journey with a seamless arrival at our private airstrip, located just a short drive from the camp. This exclusive access ensures a swift and intimate welcome to Anantara Tented Camp Kafue River.

Experience Zambia's wild wonders from the comfort of spacious tented suites amid the trees raised 3.5m above the ground. Enjoy luxury as you deepen your connection to nature. Indulge in rejuvenating therapies refined with local herbs in a unique setting over the river. Your villa includes a dedicated wellness space to enjoy private treatments with the sounds of nature, enhancing the relaxation. Balance mind and body with the healing powers of nature and spend days out exploring the reserve by road, on guided walks or cruising along the tranquil Kafue River at sunset.

Explore the culinary landscape of Zambia through its bounty of fresh ingredients from both land and river. Our talented chefs use their gourmet skills to present innovative menus infused with local flavour. 🍷

For enquiries and bookings, please contact +2710 003 8979 or email cro.jnb@minorhotels.com

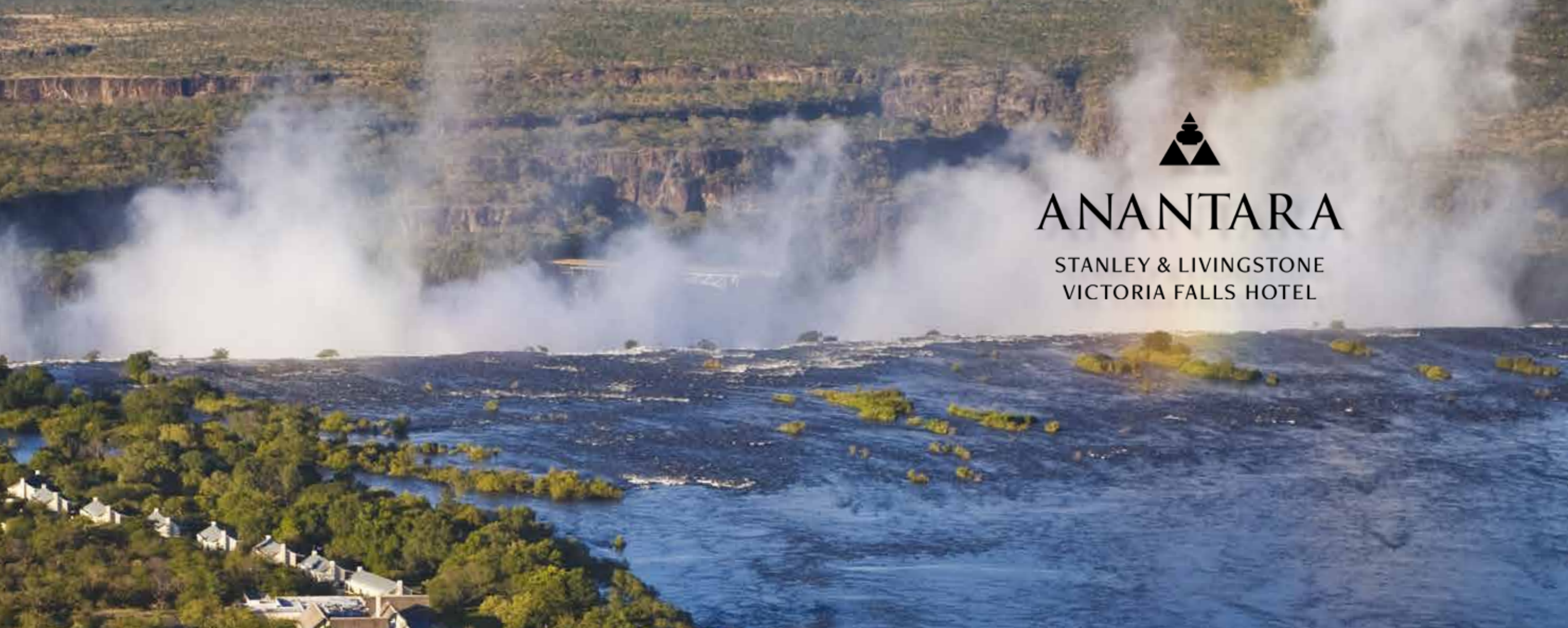

ANANTARA

STANLEY & LIVINGSTONE
VICTORIA FALLS HOTEL

Discover the wild and undiscovered side of Africa a short 15-minute drive from one of the Seven Wonders of the World and a UNESCO World Heritage Site, the mighty Victoria Falls.

With adrenaline-igniting activities, close-up wildlife encounters and an authentic cultural interaction, your days will be filled with wonder. Anantara Stanley & Livingstone Victoria Falls Hotel, the first boutique hotel in the area, is found within the Victoria Falls Private Game Reserve, a black rhino Intensive Protection Zone, on the edge of Victoria Falls town and near the Masuwe River.



Immerse yourself in the dazzling outdoors of Zimbabwe and return to boutique luxury in your spacious suite situated amid a private game reserve. With the renowned restaurant 1871 at Stanley & Livingstone, bar, pool and family-friendly amenities, it is an elegant, sustainable escape in a prime location from which to explore one of Africa's most iconic destinations.

Contemporary luxury suites overlook a waterhole and the game reserve beyond. Watch wildlife roam the reserve whilst enjoying breakfast or a sundowner cocktail from your private outdoor terrace. Victoria Falls is home to a plethora of adventure, adrenalin, cultural and experiential excursions. The art and craft markets are a shopper's delight. 🐾



France's culinary crown goes global

How international chefs are reshaping the legacy of French gastronomy

Over the last 10 years, chefs from around the world have been winning French culinary competitions at an unprecedented rate.

Visitors strolling through Paris today might notice bakeries and delicatessens proudly displaying signs claiming their baguettes or pâtés are "le meilleur" – the best. These titles are far from symbolic. France hosts hundreds of food competitions, ranging from niche certifications like the AAAAA label for andouillette (a traditional French sausage) to prestigious events such as the Glorieuses de Bresse, where the finest chicken earns the honour of being served to the French president.

Long regarded as the heart of Western cuisine and the birthplace of the Michelin Guide, France's abundance of culinary contests is no surprise. What is surprising, however, is how often recent winners have come from outside the country.

Not long ago, an English sparkling wine became the first non-Champagne to be crowned the world's best. Soon after, an American competitor won the World's Best Cheesemonger title at the Mondial du Fromage – another first.

This pattern has only intensified. In 2024, Japanese chef Taiki Mano took top honours at the World Championship of Pâté-Croûte. The previous year, Denmark's Brian Mark Hansen won the Bocuse d'Or, often referred to as the "Gastronomic Olympics." Even Paris's renowned baguette competition has increasingly been won by bakers with international backgrounds. Rather than diminishing France's influence, many experts see this trend as proof of its enduring authority in global gastronomy.



For centuries, France has shaped culinary standards, thanks in part to influential figures like Marie-Antoine Carême and Auguste Escoffier, who formalised haute cuisine and spread its techniques worldwide. Today, those methods remain foundational. As Paris-based culinary educator Allison Zinder notes, mastering French techniques equips chefs to succeed anywhere.

France's influence also extends into wine. Its reputation inspired Cherie Spriggs, head winemaker at Nyetimber in England, to enter the International Wine Challenge – often described as the wine world's equivalent of the Oscars. When her Blanc de Blancs 2016 Magnum won best sparkling wine, it marked the first time a non-French entry had taken the top prize in the competition's history.

American cheesemonger Emilia D'Albero shared a similar sense of breakthrough after winning gold at the Mondial du Fromage alongside her teammate Courtney Johnson. Historically, she explained, Americans have been seen as outsiders in the global cheese community – making the victory more significant.

Together, these milestones highlight a shift in the culinary world: while France remains a benchmark of excellence, its traditions now serve as a global language – one that chefs everywhere are mastering, and increasingly, redefining.

Brandy vs Cognac: What's The Difference?

There's more to these similar-looking brown spirits than meets the eye

Ever wondered if Cognac and brandy are the same thing? Or why one bottle can feel like it demands a butler, while another is the perfect liquor for spiked eggnog? The main difference boils down to geography and production. All Cognac is a type of brandy, but every brandy might not necessarily be Cognac. It's like how all Champagne is sparkling wine, but bubbly can only claim the prestigious title of Champagne if it comes from that specific region and is made following specific rules.

Brandy, the broad category, refers to any distilled wine-based spirit. Cognac, however, is a specific type of brandy with a fancier name and even fancier rules. It hails from the Cognac region of France and must follow strict production methods – much like how whiskey labelled "Kentucky bourbon" must be made in that state.

What really sets Cognac and brandy apart?

For starters, it's all about location. Brandy is a broad term for spirits distilled from fermented fruit juice, typically grapes. It can be made anywhere in the world, with countries like Spain, the U.S., and Italy boasting their own unique styles.

Meanwhile, Cognac must come exclusively from Cognac, France, where production is tightly regulated. The spirit undergoes double distillation in copper pot stills. It must also age for at least two years in French oak barrels. This meticulous process gives Cognac its signature smoothness and layered flavour profile, often with hints of caramel, vanilla, and dried fruit.

Curious where to begin? In cocktails, brandy is versatile and great for everything from warming winter drinks to refreshing summer sangrias. Cognac, with its premium price tag and nuanced flavour, tends to shine on its own, or in more refined cocktails. Try it in a classy two-ingredient French Connection cocktail, for example. But whichever you choose, and whether you go high-end or keep it simple, these spirits can each bring something unique to your bar cart.





KRUGER
S H A L A T I
THE TRAIN ON THE BRIDGE

Experience the Kruger suspended over the Sabie River

Whether you're looking for a one-of-a-kind adventure, an enthralling break or to simply unwind while surrounded by earth's finest creations, Kruger Shalati looks forward to welcoming you on a journey of discovery with nature in the most extraordinary way imaginable.

Unique, thought-provoking design is core to their offering, but the holistic experience is centred around humanity, cultural nuances, the people who crafted each element and, ultimately, the kindness with which they receive their guests.



GATEWAY TO WONDEROUS Africa

Situated as a gateway to the Kruger National Park, adjacent to the Skukuza Camp, Kruger Shalati offers an express entryway to freedom, relaxation and meaningful connection. Guests have convenient access to everything the park has to offer and a diverse range of other major attractions in the area.

At Shalati, you'll enjoy first-of-its-kind luxury accommodation in a re-envisioned train stationed on the historically rich Selati Bridge above the Sabie River in the Kruger National Park:

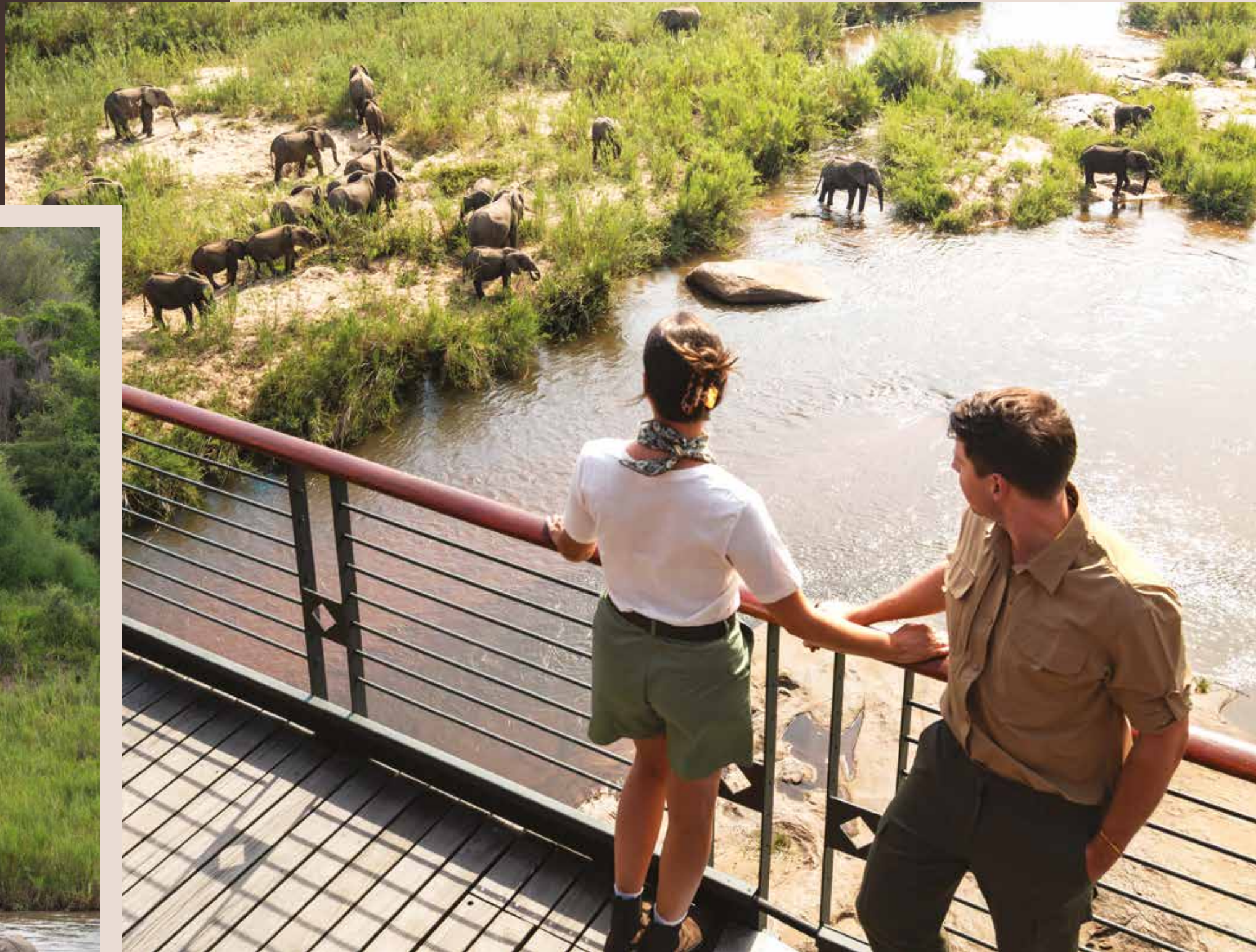

- ▮ 31 Luxury rooms, including two universal-access rooms, complemented by bespoke experiences
- ▮ Unique overhanging pool with a viewing deck on the bridge
- ▮ Boutique gift store
- ▮ African-inspired fare at the Bridge House restaurant
- ▮ Perfect positioning in the heart of Big 5 territory
- ▮ A myriad of wildlife and birds, easily spotted from your luxurious room and on game drives
- ▮ Rates inclusive of all meals, house-drinks and two game drives daily

Distances

- ▮ 0.4km away from Kruger Station lifestyle precinct
- ▮ 2km away from Stevenson-Hamilton Memorial Library
- ▮ 5.2km away from Skukuza Golf Course
- ▮ 4.9km away from Skukuza Airport
- ▮ 110km/2 hours away from Kruger Mpumalanga

How to get there

- ▮ Accessible through the Paul Kruger & Phabeni Gates
- ▮ 5-hour drive away from Johannesburg
- ▮ Complimentary airport transfers to/from Skukuza Airport



AFRICAN WARRIOR QUEEN

The train is named after Shalati, an African warrior queen. The origins of Shalati's rule go back to the nineteenth century. According to oral tradition, she was one of the first female warrior chiefs of the Tebula, a small clan within the Tsonga tribe that lived in the bush around the Murchison Range in what is now the Limpopo Province.

Legend says, this warrior hosikati (queen) was no ordinary woman. While most queens wanted a brave king to come and save them, Shalati would pick up a war axe when she needed to save her clan.

A celebration of Africa

Kruger Shalati offers two types of accommodation: 24 Carriage Suites located on the Train on the Bridge and 7 Bridge House Suites located adjacent to the bridge in a picturesque garden setting with the train's gentle glow as your backdrop.

All the rooms provide immersive comfort from the most unique location in the Kruger National Park: the historic bridge, where the very first visitors to the park had a pioneering stay within the carriages, following a night of feasting, performance and tales from times long-gone.



Kruger Shalati offers opulent accommodation with an elevated perspective – a reminder of the 1920's rail safari, with a contemporary interpretation reflective of the marvel of African design. The arrival lounge, reception and dining areas, along with two of three swimming pools, are found adjacent to the Selati Bridge, overlooking the majestic Sabie River. The river flows all year-round, drawing animals and birds that come to quench their thirst daily.

Whether you opt for a Bridge House Suite or first-of-its kind Carriage Suite on the Train on the Bridge, your experience as a valued guest is of utmost priority. The experienced, welcoming team, looks forward to making your stay Insta worthy. 📸



In the heart of South Africa's Sabi Sands, Dulini luxury safari camps offer an unparalleled experience, blending opulence with the raw beauty of the African wilderness

Dulini is a proudly family-run partnership of the Davis and Garratt clans.

In October 2012, the Garratt and Davis families were privileged to realise a longstanding dream in the acquisition of Dulini. Their friendship was forged in the early 1990s when Mick and Barbara Davis were first hosted as guests by Iain and Sue Garratt at the original Dulini Bush Camp. Their friendship is inspired by a love of the wilderness, a passion for excellence and the desire to make a significant contribution to conservation and the lives of those who journey with them.

Intrigued by the vision and success of Dulini, and their own passion for wildlife and conservation, Daniel and Marianne Gutknecht approached Iain to find

them a similar opportunity. It was with their acquisition of Exeter in 2015, that the Dulini portfolio grew to include Dulini River and Dulini Leadwood.

Experience Africa at her finest
A sanctuary of restoration, romance and adventure, carefully curated for solo-adventurers, exclusive parties celebrating life's special occasions together and romancing honeymooners alike.

Home to three magnificent wilderness sanctuaries - Dulini Moya, Dulini Leadwood and Dulini River. Combining luxury, classic elegance, fine dining, and an unforgettable wilderness experience, complemented by the Dulini Spirit.



This is where unforgettable memories are made

A luxurious escape where classic style meets indulgent comfort and embraces the thrill of a wilderness adventure, the wonder of discovery, and the unique romance of the safari tradition. Dulini invites you to explore its unrivalled and awe-inspiring hideaways.

A taste of Africa
Delight your palate on a culinary adventure that fuses global cuisine and the best local produce with the bold flavours of Africa.

It's not just about the breathtaking game drives or lavish accommodations - it's also about the culinary journey. Gourmet dining is an integral part of the luxury safari experience, with world-class chefs crafting exquisite menus that showcase the finest local ingredients.

From succulent game meats to fresh seafood, every meal is a masterclass in flavour and presentation. Pair that with exceptional service, fine wines, and al fresco dining under the stars, and you've got a truly unforgettable experience.

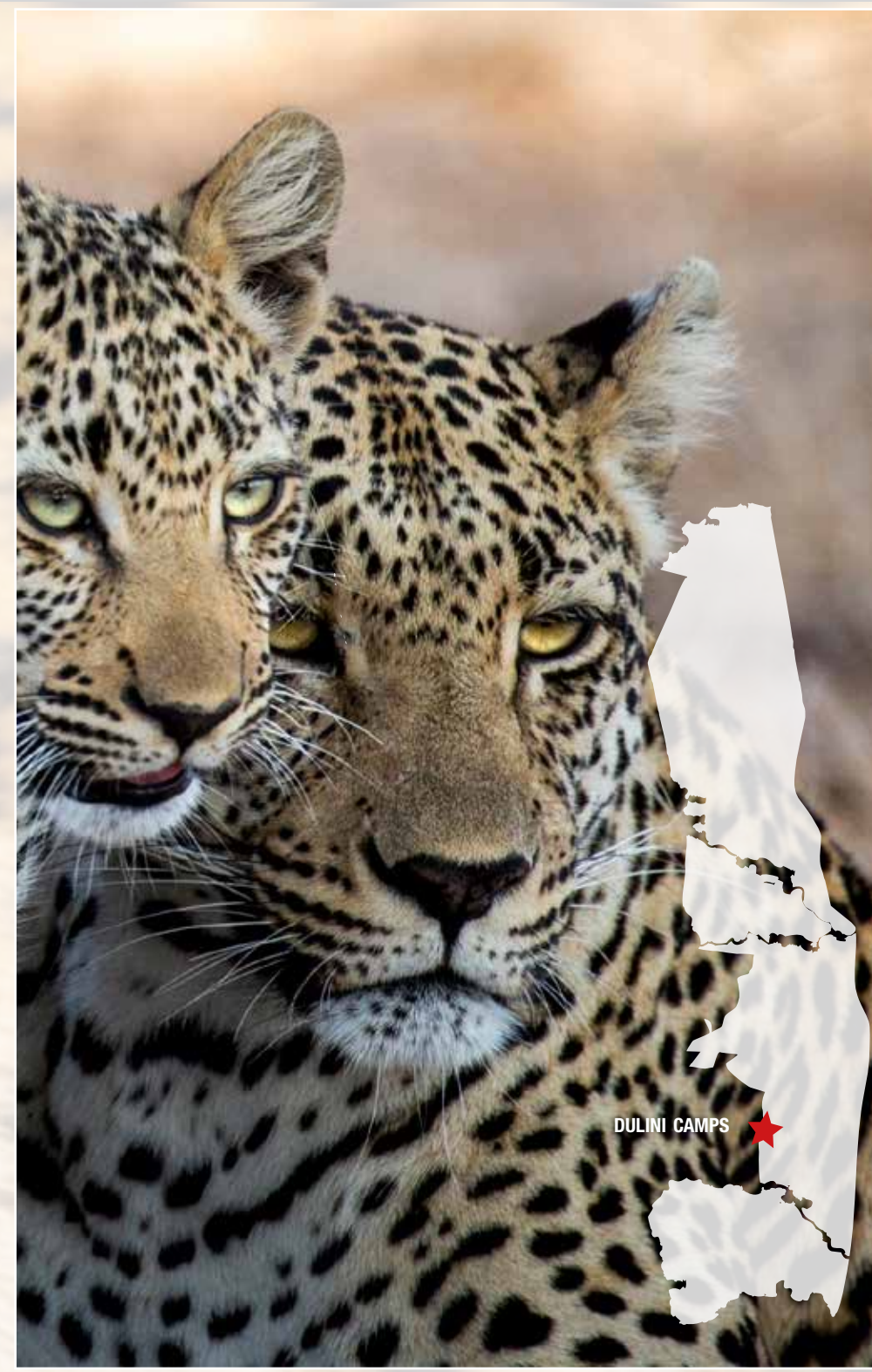

Whether you're sipping sundowners on a rocky outcrop or enjoying a bush dinner, Dulini luxury safari camps redefine the art of indulgence.

Embrace wellness
Amid the thrilling wilderness adventures, Dulini invites you to carve out time to rest, indulge your senses and rejuvenate your body and mind.

It's not just about the food - it's about nourishing body and soul. Imagine indulging in rejuvenating

beauty treatments under the open sky, surrounded by the sights and sounds of nature. From massage therapy to holistic wellness programmes, Dulini luxury safari camps offer a range of treatments designed to harmonise body, mind, and spirit. As you bask in the warmth of the African sun, let the stresses of everyday life melt away, and emerge feeling refreshed, revitalised, and reconnected to the natural world. It's wellness in its purest form - and it's an experience that will leave you glowing from the inside out. 🦁

ZWAHILI

PRIVATE GAME LODGE & SPA

A HIDDEN WATERBERG RETREAT

Just two hours from Johannesburg – perfect for bush getaways, wildlife encounters, and unforgettable family gatherings.

Hidden among the rolling mountains and wide-open bushveld of the Bushveld Region in Limpopo lies Zwahili Private Game Lodge & Spa, a peaceful escape where nature takes centre stage. Far away from the noise of busy cities, this lodge offers visitors the chance to slow down, breathe in fresh bush air, and experience the magic of the African wilderness in a malaria free area. Whether you are looking for adventure, relaxation, or simply a break from everyday life, Zwahili Private Game Lodge & Spa delivers an unforgettable experience.

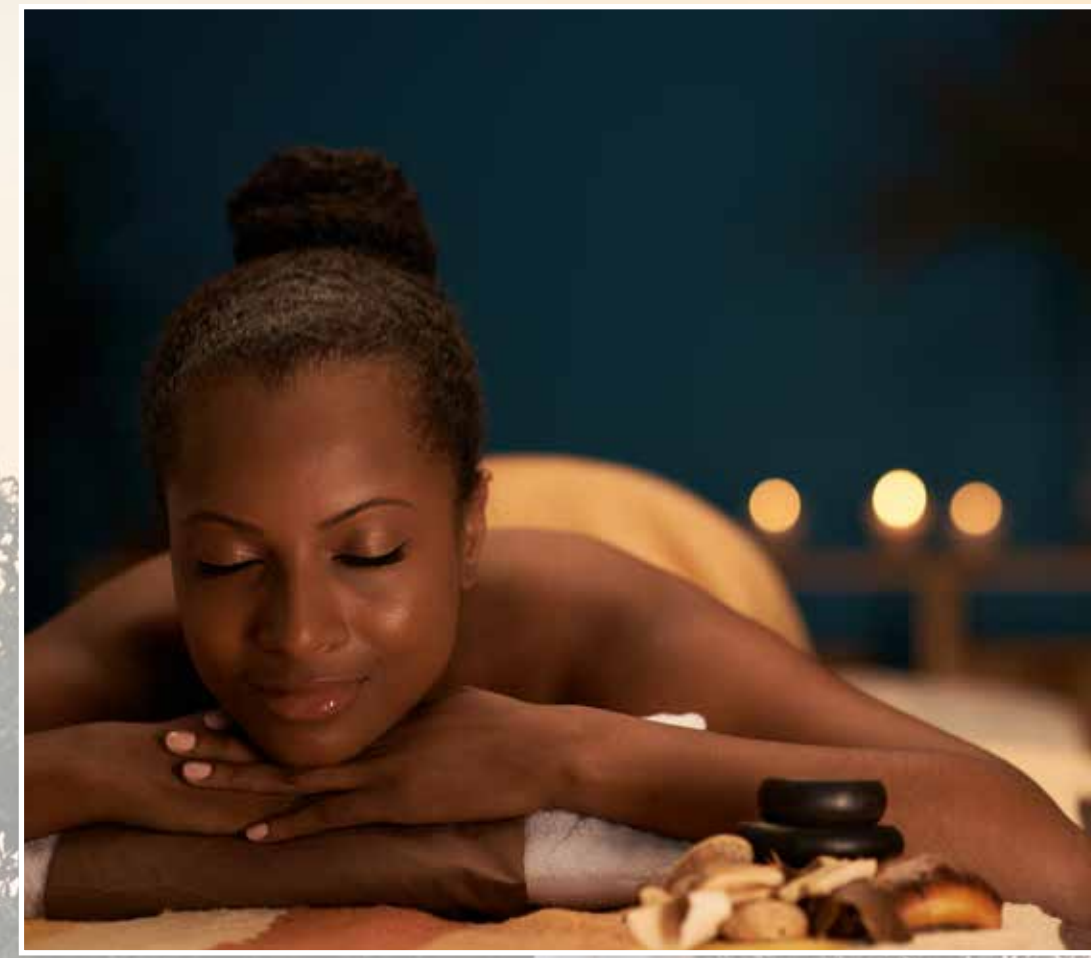

From the moment you arrive, the beauty of the region immediately stands out. The area is famous for its combretum bushveld, kopjes & plateaus, and incredible sunsets that paint the sky in shades of orange, pink, and purple. Zwahili Private Game Lodge & Spa sits comfortably within this scenery, blending naturally into the surrounding bushveld. It feels like a hidden gem where guests can enjoy both luxury and the wild outdoors at the same time.





Delicious meals are prepared using fresh ingredients and often feature traditional South African flavours. In many ways, Zwahili combines the best of both worlds: the peace and beauty of the African bush with the convenience of being close to a major city. Two hours from Johannesburg and the option to book the entire lodge make it a fantastic venue for families and friends who want to celebrate, reconnect, and enjoy time together in a truly special setting. 🍷

The surrounding reserve is home to a variety of animals such as zebras, giraffes, antelope, and many different bird species. Guests can explore the area on game drives or guided walks, where every trip into the bush feels like a small adventure. You never quite know what you might see around the next corner, which makes the experience even more thrilling. Enjoy a spa treatment or a romantic bushveld picnic for 2.

Within walking distance from the main lodge rooms are lantern lit paths leading to the safari suites, executive suites and presidential suite. Personal experience accommodating a maximum of 20 guests. The lodge is also perfectly suited for small weddings and EXCO meetings.

The chalets are comfortable, stylish, and designed to make guests feel relaxed while still being close to nature. Large windows and private patios allow visitors to take in the incredible views of the bushveld right from their rooms.

In the evenings, many guests enjoy sitting outside and listening to the natural sounds of the bush, from birds calling to the distant rustle of animals moving through the grass. Food is another highlight of the Zwahili experience.





WATERING HOLE

Avis Safari Rental gives you more than one way to go enjoy your outdoor adventure.

Quench your thirst for travel with Avis Safari Rental. Alone. With friends. With a group. Or on business. That's why our mobility solutions keep evolving to suit your safari requirements. With more than one adventure to go explore, Avis offers more than one way to go enjoy being out there.



Visit www.avis.co.za/safari-rental for more details.
Visit our stand No. R28

931-WTM/AFRICA26





The Iconic Millennium
Ring set with a one carat
round brilliant cut, South
African diamond.

SHIMANSKY

SHOP AT SHIMANSKY: THE V&A WATERFRONT, SHOP 7228 | THE CLOCKTOWER WATERFRONT
THE SHIMANSKY ROCKWELL, CNR PRESTWICH & ALFRED STREET GREEN POINT | WWW.SHIMANSKY.COM